

PRICE LIST 23/24 EN-DE

valid from 01.01.2024

**NEW**  
REVOLUTIONARY  
UNIQUE



**c-tourer**  
superior

REVOLUTIONARY. UNIQUE.

THE NEW C-TOURER | 145 RB LE SUPERIOR

Maximum comfort, exclusive Liner genes, light weight, all with a compact vehicle length of just 7 metres – a unique layout like never before!



AL-KO



Mercedes-Benz

AL-KO

**carthago**<sup>®</sup>  
Das Reisemobil.



# STANDARD EQUIPMENT AND HIGHLIGHTS

- + A-class premium motorhome with gross weight of 3.5 t or 4.5 t possible
- + Available on the Fiat Ducato or Mercedes-Benz Sprinter basic vehicle with numerous safety systems
- + Carthago full LED headlights (dipped and main beam) including LED daytime driving lights
- + Extended and exclusive exterior décor with dynamic lines and the “C”-branding that is typical of Carthago, including the “superior” logo
- + Scooter garage with extra-large interior height
- + High-stability body connection using frame members bonded over their entire surface
- + Inner walls and inside of roof made from aluminium and micro-fibre climate-regulating wall covering
- + Modern dynamic designer rear
- + Carthago driver’s cab visibility concept with dashboard lowered towards the front for even earlier visual contact with the road surface
- + Unique double floor with large, heated and through-loadable storage compartment, conveniently accessible from the inside and the outside
- + New “innovista” furniture design and new “nuovo” world of style – straight design lines, handle-less overhead storage cabinet flaps in the living area, modern contrasts in anthracite black combined with high gloss ivory and brilliant ash furniture décor
- + L-shaped lounge seating area with lift-up side seat bench and 360° living area table
- + 32" smart LED TV with wall bracket\* integrated at a convenient viewing height in the entrance area and decorative element with stylish lamella look on the outer wall of the washroom
- + Comfort corner kitchen with large work surface and elevated kitchen worktop for visual room partitioning and as additional storage
- + Comfort luxury bathroom with separable changing room
- + Large lengthways single beds with access steps
- + Wardrobes with extra-large interior height beneath the lengthways single beds

Before choosing and configuring your motorhome, please carefully read the legal and technical notes concerning weight-related information. To do this, simply scan the following QR code.

\* optional



# TECHNICAL DATA

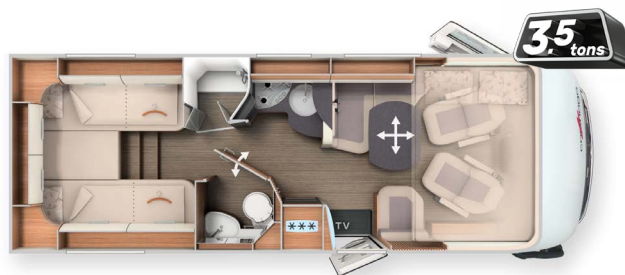

	<b>I 145 RB LE superior</b>	
	Fiat Ducato	Mercedes-Benz Sprinter
Basic vehicle	AL-KO low frame 35 light	AL-KO low frame 415 CDI
Standard chassis	Diesel 2.2 l (140 HP / 103 kW)	Diesel 2.0 l (150 PS / 110 kW)
Basic engine	7040 / 2270 / 2920	7180 / 2270 / 2950
Length / width / height (mm) <sup>1)</sup>	3800	3900
Wheel base (mm)	220 / 460	
Double floor height / double floor storage compartment (mm)	1980	
Headroom in living area (mm)	1200	
Garage interior height (mm)	1050 x 1140	
Door width / height, rear garage at passenger side (mm)	1050 x 1140	
Door width / height, rear garage at driver's side (mm)	3,500 / 4,500 *	
Tech. permissible gross vehicle weight (kg)	3,085 (2,931 - 3,239)	3,145 (2,988 - 3,302)
Weight in running order (kg)	50	96
Max. weight of additional equipment in series production specified by the manufacturer (kg)	2,000	
Max. towing capacity (kg)	4	3 / 4 *
Maximum number of seats while driving with 3-point seat belt (standard/optional)	4 / 5 *	
Sleeping berths (standard / optional)	1900 / 2000 x 850	
Rear bed dimensions (mm)	1950 x 1600	
Drop-down bed dimensions (mm)	2030 x 1105 / 650	
Seating area bed conversion dimensions (mm)*	133 / 12	
Fridge volume / of which freezer compartment (l)	Truma Combi 6	
Heating system	150	
Fresh water tank volumes (l)	20	
Fresh water tank volume with filling in driveable condition (l)	140	
Waste water volume (l)	80	
Battery capacity (Ah)	5 / 2 / 2	5 / 1 / 1
230 V / 12 V / USB sockets	110150	110540
Article no.		

<sup>1)</sup> Total vehicle width is the measurement from exterior wall to exterior wall (wheel arches on the side, approx. + 70 mm)

\* in conjunction with special equipment

# EQUIPMENT PACKAGES

Article no.

216002

213002

<b>Basic-Plus package</b>	<b>Weight</b>	<b>Fiat</b>	<b>Mercedes-Benz</b>
	<b>kg</b>	<b>EUR</b>	<b>EUR</b>
<b>Chassis options</b>			
Wheel trims		-	80
Carthago wheel trims		80	-
Driver's cabin automatic air conditioning		540	-
Tempmatik semi-automatic air conditioning system		-	2900
Cruise control		Standard	520
Higher output alternator		210	210
92 litre fuel tank		-	460
Front axle with increased load bearing capability		-	490
Steering wheel with multifunctional buttons option (incl. leather gearshift lever with manual transmission)		-	430
Instrument cluster with colour display		-	540
Rain sensor		-	230
Electric handbrake		-	570
"Carthago best view" bus mirror system in black/white, adjustable and heatable		410	410
Driver's cabin comfort seats with tilt and height adjustment (front / rear)		580	580
Dashboard finish: Ventilation grille in chrome		240	-
Wiring for radio with roof antenna with DAB+ . speakers (4 x)		450	450
Pioneer 6.8" radio / moniceiver incl. DAB+		650	650
<b>Main cabin options</b>			
Midi-Heki skylight with LED spotlights above the L-shaped lounge seating area		690	690
Large scooter garage door at driver's side		580	580
XL habitation door "premium two 2.0" (width 63 cm) with double locking, window and integrated insect blind		530	530
SOG toilet ventilation via roof chimney		370	370
Waste water hose set for easy disposal		120	120
USB socket in overhead storage cabinet above rear bed		110	110
Wiring for electric roof-mounted fan		240	240
Wiring for solar system		240	240
Wiring for satellite system		240	240
Wiring for reversing camera (single lens)		240	240
<b>Total price of individual options</b>		<b>6.520</b>	<b>11.880</b>
<b>Package price</b>	<b>42,5/ 66,5</b>	<b>5.450</b>	<b>10.340</b>
<b>Your savings</b>		<b>1.070</b>	<b>1.540</b>
210330 <b>SURCHARGE</b> Pioneer 9" media centre incl. navigation, motorhome route guidance, DAB+	-	910	-
210335 <b>SURCHARGE</b> MBUX 10.2" multimedia incl. navigation and DAB+ *	0.5	-	3.640
210336 <b>SURCHARGE</b> THERMOTRONIC fully automatic air conditioning system	-	-	630

\* MBUX 10,2" Multimedia will be compulsory with Mercedes-Benz models from January 2024

# EQUIPMENT PACKAGES

Article no.

216500

216501

<b>3.5 t package for weight reduction</b> (only in conjunction with f35/m35)	<b>Weight</b>	<b>Fiat</b>	<b>Mercedes-Benz</b>
	<b>kg</b>	<b>EUR</b>	<b>EUR</b>
60 l fuel tank (instead of standard 90 l fuel tank)		✓	-
65 l fuel tank (instead of 92 l fuel tank from the Basic Plus package)		-	✓
90 Ah lithium-ion battery incl. battery computer instead of 80 Ah gel battery		✓	✓
Omission of SOG toilet ventilation via roof chimney		✓	✓
Omission of waste water hose set for easy disposal		✓	✓
Omission of wiring for solar system		✓	✓
<b>Package price</b>	<b>-39,5</b>	<b>1.490</b>	<b>1.490</b>

Article no.

216009

<b>Fiat Infotainment package*</b>	<b>Weight</b>	
	<b>kg</b>	<b>EUR</b>
Digital instrument cluster with colour display in dashboard		✓
Leather steering wheel and gear lever, including multifunctional buttons		✓
Fiat 10.1" multi-media system incl. navigation, motorhome route guidance and DAB+		✓
<b>Package price</b>	<b>2</b>	<b>2.790</b>

\* The Fiat 10.1" multimedia system replaces the Pioneer 6.8" radio / moniceiver and has been taken into consideration in the price.

Fiat infotainment package not possible in conjunction with the Pioneer 9" media centre

Article no.

212315

<b>Mercedes-Benz driver's assistance package*</b>	<b>Weight</b>	
	<b>kg</b>	<b>EUR</b>
Active distance assistant DISTRONIC		✓
Active braking assistant		✓
Active alertness assistant		✓
Tyre pressure monitoring system		✓
<b>Package price</b>	<b>2</b>	<b>1.890</b>

\* Only in conjunction with MBUX 10.2" multimedia and 9G-Tronic automatic transmission

# EQUIPMENT PACKAGES

Article no.

212011

<b>Media package</b>	<b>Weight</b>	
	<b>kg</b>	<b>EUR</b>
Reversing camera system with single lens and 7" colour monitor at side in dashboard		1.150
TV wall bracket		710
32" Smart LED TV		1.980
Total price of individual options		3.840
<b>Package price</b>	<b>21/22</b>	<b>2.790</b>
Your savings		1.050
210305 <b>SURCHARGE</b> for reversing camera with double lens and shutter instead of single lens	1	690
210211 <b>SURCHARGE</b> Teleco Flatsat Classic 85 satellite system with CI slot	28	2.970

Article no.

810633

<b>Living comfort package</b>	<b>Weight</b>	
	<b>kg</b>	<b>EUR</b>
Pull-out lightweight access steps including sleeping area extension		✓
Multifunctional sink cover for additional wall holder for extending work surface		✓
Additional mirror element in luxury bathroom		✓
Shelving beneath the lengthways single beds		✓
<b>Package price</b>	<b>12</b>	<b>690</b>

Article no.

210730

<b>Kitchen / coffee package</b>	<b>Weight</b>	
	<b>kg</b>	<b>EUR</b>
Inverter for 12 V to 230 V, 1,800 Watts, mains priority circuit*		1.150
Capsule coffee maker with connecting kit incl. pull-out system		710
Total price of individual options		2.270
<b>Package price</b>	<b>12</b>	<b>1.930</b>
Your savings		340

\* Only in conjunction with second main habitation battery (gel) or lithium

# SPECIAL EQUIPMENT

Article no.		€ incl. 20 % VAT	kg	
<b>Fiat Ducato chassis</b>				
310021	140 HP / 103 kW engine, Euro 6d Final, f35 light, 9G automatic converter	3.990	55	○
310024	180 HP / 132 kW engine, Euro 6d Final, f35 light, manual gearbox	4.510	20	○
310025	180 HP / 132 kW engine, Euro 6d Final, f35 light, 9G automatic converter	8.500	55	○
310026	180 HP / 132 kW engine, Euro 6d Final, f40 heavy (total permissible weight 4.250 kg), manual gearbox	6.660	60	○
310027	180 HP / 132 kW engine, Euro 6d Final, f40 heavy (total permissible weight 4.250 kg), 9G automatic converter	10.650	61	○
330330	Fiat 16-inch alloy wheels for f35 light chassis in conjunction with manual gearbox	1.090	22.5	○
330340	Fiat 16-inch alloy rims for f40 heavy chassis / f35 in conjunction with 9G automatic torque converter transmission	890	-8	○
310467	Weight increase from 4.250 kg to 4.500 kg with Fiat Ducato f40 heavy	340	-	○
<b>Mercedes-Benz Sprinter chassis</b>				
310147	Engine variant 170 HP / 125 kW, Euro VI E (only in conjunction with automatic transmission)	2.860	-	○
310402	9G-TRONIC automatic transmission incl. hold function	3.490	30	○
330351	16-inch alloy wheels (black) with all-weather tyres	1.500	2	○
310465	Increased load from 3.500 kg to 4.200 kg	340	-	○
310466	Increased load from 3.500 kg to 4.500 kg	580	-	○
410011	Entrance step, passengers cabin access, retracted and extended electrically	580	5	○
<b>Other Fiat / Mercedes-Benz chassis options</b>				
331620	Fog light	350	4	○
311300	Crank-operated rear supports to prevent swaying in standing position	440	10	○
<b>Habitation exterior</b>				
410121	Central locking for XL habitation door "premium two 2.0" and passengers door	460	-	○
410150	Additional security locks in the driver's cabin door and habitation door	710	2	○
410560	Aluminium roof mounted awning frame, grey canvas, length: 4.5 m	1.870	42	○
410850	Electric roof-mounted fan above kitchen area	520	5	○
<b>Electrical system</b>				
510020	Additional 80 Ah main habitation battery in existing battery centre	540	26	○
510053	Lithium-ion battery 150 Ah incl. battery computer and separate touch display	2.410	-9	○
510081	Solar panel system: 2 x 100 Watts	1.990	13	○
510255	Socket package with additional sockets (3 x 230 V, 2 x USB)	490	3	○
510201	Carthago Security alarm system	1.420	3	○

○ = special equipment X = standard equipment - = not available

Further and detailed information about special equipment can be found online at [www.carthago.com](http://www.carthago.com).

# SPECIAL EQUIPMENT

Article no.		€ incl. 20 % VAT	kg	
<b>Gas   Water   Miscellaneous</b>				
610020	Truma DuoControl CS	440	3	○
610021	Gas filter for Truma DuoControl CS (recommended)	220	0.5	○
610480	Scooter garage upgrade with needle felt, luggage nets	350	10	○
610500	Aluminium chequered floor for scooter garage	180	20	○
<b>Kitchen   appliances</b>				
550067	Gas oven with grill function in kitchen base unit	1.060	12	○
<b>Heating</b>				
650040	Truma Combi 6E (additional electric heating element 2 x 900 Watt / 230 V)	740	1	○
<b>Interior</b>				
810100	Carpet for living area	370	6	○
810120	Carpet for driver's cabin area	190	1	○
810440	Drop-down bed omitted, replaced with all-round overhead storage compartments in driver's cabin	660	-26	○
810580	Lounge seating area can be converted into a sleeping area	590	10	○
810610	Solid wood sliding door in front of bedroom	410	13	○
<b>Living area materials</b>				
850304	London (25) fabric combination	Standard	-	X
850314	Paris - quilted fabric combination	420	-	○
850640	Davos - textile leather / fabric combination	420	3	○
850710	Ivory part leather - leather / fabric combination	1.490	7	○
850690	Ivory leather	3.680	10	○
850730	Sand leather	3.680	10	○
850740	Macchiato leather	3.680	10	○
850501	World of sleeping & decoration set: Decorative cushions, bed throw, fitted sheet set	410	7	○

○ = special equipment X = standard equipment - = not available

Further and detailed information about special equipment can be found online at [www.carthago.com](http://www.carthago.com).