

PREMIUM CLASS 2023

# COACHBUILT



**carthago**<sup>®</sup>

Das Reisemobil.

# Table of contents

<b>Carthago – more than just a company</b>	<b>3</b>
<b>The premium coachbuilt motorhome</b>	<b>8</b>

LIGHTWEIGHT PREMIUM CLASS



<b>c-tourer T Lightweight</b>	<b>10</b>
-------------------------------	-----------

The c-tourer Lightweight 3.5 t models impress with their short vehicle lengths of less than 7 m, their perfect handling and an amazingly light own weight. Thanks to the Carthago lightweight construction technology, they are ideal for certification within the 3.5 t weight class



AL-KO



Mercedes-Benz  
AL-KO

COMFORT PREMIUM CLASS



<b>c-tourer T Comfort</b>	<b>10</b>
---------------------------	-----------

If certification within the 3.5 t weight class is not essential and comfort is more important than weight, the c-tourer Comfort models offer the right solution



AL-KO



Mercedes-Benz  
AL-KO



<b>chic c-line T</b>	<b>36</b>
----------------------	-----------

The fascination of the Carthago premium class: elegance, comfort and extravagance



AL-KO



Mercedes-Benz  
AL-KO

<b>The Carthago worlds of living</b>	<b>54</b>
--------------------------------------	-----------

<b>The Carthago Premium DNA</b>	<b>58</b>
---------------------------------	-----------

<b>Our powerful partners</b>	<b>76</b>
------------------------------	-----------

More information at [www.carthago.com](http://www.carthago.com)



We have put together a great deal of additional information for you on our web page! Be it videos, 360° views or technical background information – let yourself be spirited away into the world of fascinating Carthago motorhomes! Simply scan the QR codes in the catalogue with the camera of your Smartphone or tablet, and let yourself be taken straight to the topic.



Newsletter sign up



YouTube



Facebook



The people behind the family-run company are: Sabrina Schuler, Karl-Heinz Schuler and Sebastian Schuler

## Carthago – more than just a company

Dear motorhome enthusiasts,

More than 40 years of the Carthago Group also means more than 40 years of the premium concept, diversity and technical know-how.

Many things have grown within this time: our head office with production and a large sales exhibition in Aulendorf in Upper Swabia, and our plant in Odranci/Slovenia. The number of employees has also increased to more than 1500, we have more than 200 partners in Germany and abroad, and the diversity of our vehicles has expanded with numerous different models.

However, one thing hasn't changed: despite the use of state-of-the-art manufacturing methods, each Carthago has been manufactured with care and a considerable amount of craftsmanship and attention to detail for more than 40 years. We have put our heart and soul into the development of the Carthago Group.

The only people we are indebted to are you, our customers. This independence was confirmed with the establishment of the Carthago family foundation in 2014, and will remain so in the future. You can put your trust in this as much as our

employees do: the Carthago Group remains a dynamic family-run company with a great deal of motivation and passion, characterised by personal commitment.

In order to ensure that our premium claim will also continue for future decades, we implement ideas quickly, think innovatively and abide by our Carthago Premium DNA. See for yourself: visit us online, at exhibitions, at Carthago City or at one of our dealers. We look forward to seeing you!

**Yours, Karl-Heinz Schuler**

Founder, owner and foundation chairman



## The Carthago Premium DNA

We find that only the best is good enough

Carthago has been an independent family-run company and permanent feature at the pinnacle of the motorhome industry for more than 40 years. Company founder and owner Karl-Heinz Schuler talks about what constitutes the Carthago premium DNA, why every Carthago motorhome is something very special and what unites the two at the same time.

**Mr. Schuler, when did you decide to work in the caravaning industry?**

**KARL-HEINZ SCHULER** Panel Van Conversions caught my attention on many occasions whilst I was studying. I examined them more closely at the time, and something became clear to me in an instant: we can do better than that! The foundations for Carthago were laid with this idea and motivation.



Long-lasting. High stability.

**Carthago Liner  
premium-class  
body construction**

Space guaranteed.

**Carthago double floor  
with huge storage  
compartment**

Well-balanced. Optimum distribution.

**Carthago payload &  
weight and balance**



***Carthago has evolved into a premium manufacturer since 1979. Did you anticipate this success story at the time?***

**KARL-HEINZ SCHULER** No-one could have known that we would be so successful, nor could it have been planned. Our goal was always to build the best high-end motorhomes. We want to have satisfied customers. Success and growth then follow naturally.

***What is the secret of your success?***

**KARL-HEINZ SCHULER** The secret of our success is the Carthago inventive spirit. We are the leading innovator in the motorhome industry, we maintain our quality claim with every model series, and we are a pioneer within the industry time and time again. All of this is anchored in our Carthago premium DNA.

***What does Carthago Premium DNA stand for?***

**KARL-HEINZ SCHULER** Our Carthago premium DNA is our promise of value to our customers which can be found in every one of our motorhomes, it is motivation and an obligation at the same time. It is characterised by the Carthago bodywork, the biggest storage space system in its class, the well thought-out heating and air conditioning technology,

the highest payload reserves, our driving safety and visibility concept and the Carthago personality. We are simply exceptional: our materials, our jointing technology and the weight and stability demands are even similar to those of aircraft technology. We are quite rightly the European market leader for A-Class motorhomes in the price class of over € 95,000\*. Because a Carthago is simply unmistakable!

***How do Carthago drivers benefit from the premium DNA?***

**KARL-HEINZ SCHULER** Our core expertise is in motorhomes in the Liner premium class. Our 40 years of experience in this area flow into every stage of development and manufacturing. We think that only the best is good enough for the comfort and safety of our customers! Not only do we provide maximum durability and value retention, safety, protection and comfort. It is just as important to us to implement every idea and every innovation in practice, and make everyday travelling as enjoyable as possible. This applies to all of our vehicles – be it a 3.5 t lightweight model or the liner class above the 3.5 t weight class. In this way, each Carthago is a synonym for exclusivity and quality. Or, to put it simply, Carthago stands for “The Motorhome”.

Well-being – all year round.

**Carthago heating & air conditioning technology**

Unique. Unmistakable.  
Extravagant.

**Carthago Personality**



Carthago company headquarters in Aulendorf, Upper Swabia, with the company's own pitches and large showroom.

## Carthago City

### Welcome

Down-to-earth and open minded at the same time, that is Carthago culture. We have remained true to our roots with the company headquarters in Carthago City in Aulendorf/ Upper Swabia, between Ulm and Lake Constance.

As well as the manufacturing facility for our Premium motorhomes, a large sales exhibition, the service centre for end customers and service partners and also the company headquarters are concentrated here.

Carthago is a popular destination for domestic and foreign motorhome enthusiasts. Visitors with a motorhome are welcome on the company's own pitch!

You can discover numerous models in our large sales exhibition during a visit – and the Carthago experts on site will be pleased to advise you.

Convince yourself of the combination of perfect craftsmanship with high-tech components and state-of-the-art methods on a factory tour.

Of course, premium service is a constituent of the Carthago premium motorhome. About 200 dealers and service centres throughout Europe look after you and your Carthago motorhome. Wherever you live, wherever you roam: Carthago is never far away! The initial contact is your local dealer, and a close-knit trade and service partner network is at your side throughout Europe during your travels.

All of our dealers and service centres are trained as certified Carthago Partners in a multi-level academy programme.

However, exceptional situations don't stop at closing time. This is why Carthago has set up an emergency breakdown number which travellers can obtain technical assistance with problems, even at the weekend and during public holidays.



Take a look behind the scenes with a factory tour! Simply register your preferred date on our web site at [www.carthago.com](http://www.carthago.com).



## The fascination of the premium coachbuilt

### Dynamic and comfortable – simply Carthago

They are the coupés among motorhomes – flat, stylish and dynamic. The slender driver's cabin gives you a feeling of security and gives the motorhome great handling. The flat profile of the roof connection optimises the aerodynamics and gives coachbuilt motorhomes a bit of sportiness for the way.

An attractive side-effect: because of the original driver's cabin of your basic vehicle, the coachbuilt motorhomes are always somewhat more cost-effective than the elaborate A class motorhomes. Therefore the coachbuilt models represent the perfect entry level to the world of Carthago motorhomes.

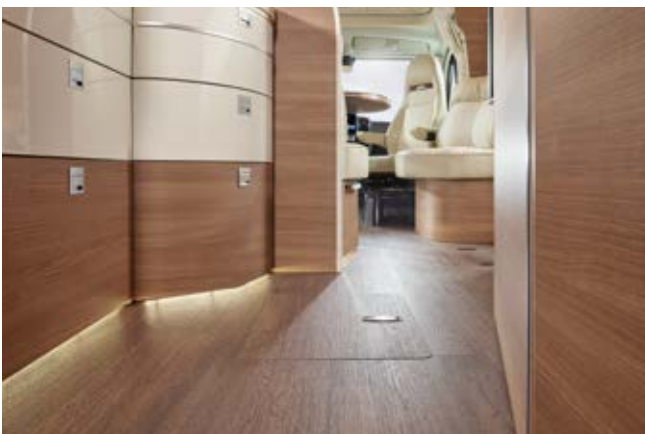

**Single continuous living area floor** from rear to driver's cab



**All-round overhead storage cabinets** cabinets above the driver's cab with ample storage space and indirect lighting (picture shows optional "skyview" skylight)





**Optional central drop down bed\***: electrically operated, large sleeping area and large sitting height, headroom beneath the bed in living mode 184 cm



**Driver's cab integration** in living area, large L-shaped lounge seating area with side seat bench (picture shows optional "skyview" skylight)

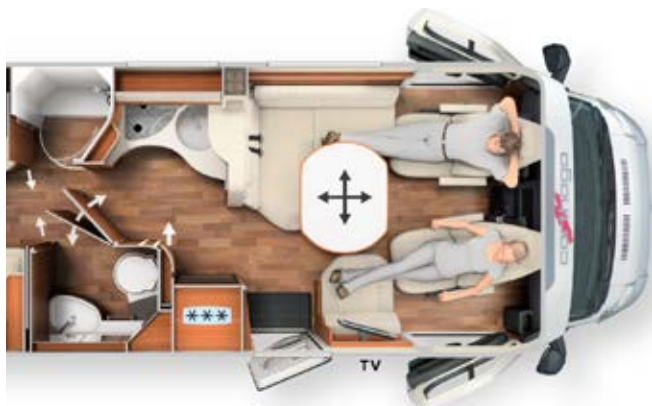

**Relaxed TV viewing position**: the driver's cabin seats can be rotated by 360°



**Comfortable sitting position** at living area table, all seats integrated

\* depending on model

# c-tourer



AL-KO



Mercedes-Benz

AL-KO

## The sophisticated all-rounder

A unique entry into the Carthago premium class: the c-tourer T has all of the advantages of a Carthago with an amazingly attractive price-performance ratio. With two basic vehicle versions, a habitation width of 2.27 m and maximum living comfort, the c-tourer surpasses every requirement of the premium class.

## c-tourer Lightweight

The c-tourer Lightweight models impress with their short vehicle lengths of up to 7 m, their perfect handling and an amazingly light own weight. Thanks to the Carthago lightweight construction technology, they are ideal for certification within the 3.5 t weight class.

## c-tourer Comfort

If certification within the 3.5 t weight class is not essential and comfort is more important than weight, the c-tourer Comfort models are the right solution.



### c-tourer Lightweight

Model: T 143 LE

- + Lightweight model with a practical payload, also in the 3.5 t weight class, thanks to Carthago lightweight construction technology and a short vehicle lengths of 6.90 m (Fiat Ducato)/7.06 m (Mercedes-Benz Sprinter)
- + Optionally also available with a gross weight of up to 4.5 t and therefore more payload



### c-tourer Comfort

Models: T 148 LE, T 148 LE H, T 149 LE, T 150 QB

- + Comfort-oriented layouts from a vehicle length of 7.34 m
- + Considerable feeling of spaciousness and high payload reserves with a gross weight of up to 4.5 t



AL-KO



Mercedes-Benz  
AL-KO

#### Chassis

- + Fiat Ducato 35 light/40 heavy or Mercedes-Benz Sprinter 414 CDI\*, special Carthago AL-KO low frame chassis with 198 cm wide wheelbase rear axle



#### Living comfort

- + "Smartline plus" furniture design, choice of two worlds of style
- + Stepless, continuous floor in living area
- + L-shaped lounge seating area with ergonomically designed upholstery, wide side seat bench and 360° rectangular living area table with chrome piping
- + Galley kitchen, corner kitchen or comfort corner kitchen\* with six large drawers, raised kitchen worktop for visual room partitioning and as additional storage
- + Different washroom solutions: maximum comfort with private changing room
- + Extra-large beds with sleeping areas up to 200 cm in length



### Storage space

- + Double floor with huge heated storage compartment with usable height of up to 55.5 cm
- + Exterior access via several large hatches, convenient access from the inside via the seat bench cover of the L-shaped lounge seating area and the lift-up side seat bench
- + Large, central through-loading space (interior height 22 cm) with extra-low double floor storage compartment (usable height 46 cm) and large, self-supporting living area floor hatch
- + Scooter garage: interior height up to 120 cm\*, loadable up to 350 kg



### Self-sufficiency/equipment

- + 150 l fresh water, 140 l waste water
- + 1 x 80 Ah gel battery (extendible to 2 x 80 Ah)



### Air conditioning/heating

- + Truma Combi 6 warm air storage heating system optional Alde warm water heating\*
- + Double floor with underfloor heating effect



Many c-tourer models also available on the Mercedes-Benz Sprinter with AL-KO low frame chassis – see model overview and price list!



\* depending on model

# epic world of style as standard

Venezia world of living | picture shows T 148 LE H with central drop-down bed option





# Optional casablanca world of style

Barcelona (23) world of living | picture shows T 150 QB





# Living area features

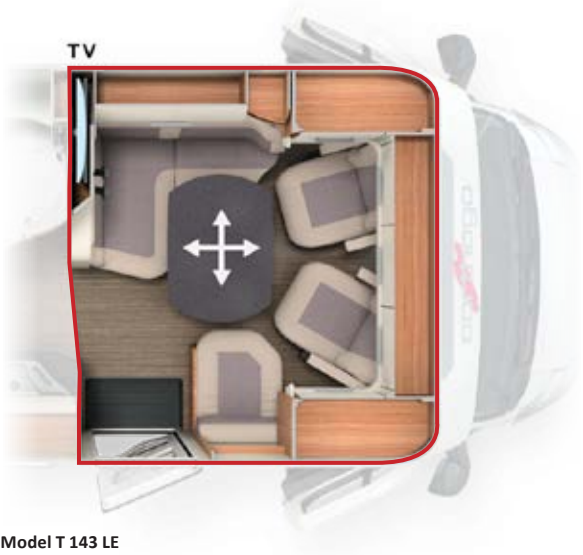

Model T 143 LE

## L-shaped lounge seating area with lift-up side seat bench

- + 360° living room table with chrome piping, rotatable using a foot pedal and movable in two directions
- + Exclusive lighting concept with LED technology, main light with numerous spotlights and separately switchable indirect ambient light
- + Swivel-out shoe cabinet with holding system for up to four pairs of shoes integrated into the plinth of the seat bench, including LED mood light
- + TV pull-out system above L-shaped lounge seating area for 24" LED flat screen\* or elegantly integrated designer TV cabinet for 32" LED flat screen\*
- + Easy access to storage compartment without removing the upholstery thanks to seat bench cover of the L-shaped lounge seating area with patented fitting and lift-up side seat bench
- + Level passage from living area to driver's cabin without tripping hazards

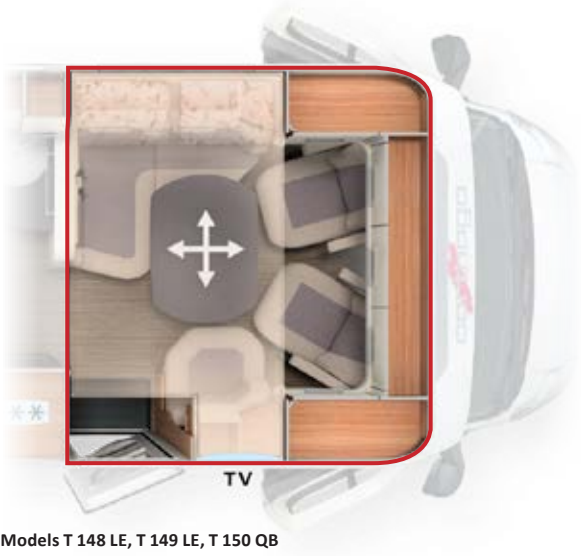

Models T 148 LE, T 149 LE, T 150 QB

## Large L-shaped lounge seating area with wide, lift-up side seat bench

- + 360° living room table with chrome piping, rotatable using a foot pedal and movable in two directions
- + Exclusive lighting concept with LED technology, main light with numerous spotlights and separately switchable indirect ambient light
- + Swivel-out shoe cabinet with holding system for up to four pairs of shoes integrated into the plinth of the seat bench, including LED mood light
- + TV pull-out system "Quick up" behind side seat bench backrest for 24" LED flat screen\*
- + Easy storage compartment access without removing the upholstery via the seat bench cover of the L-shaped lounge seating area with patented fitting and lift-up side seat bench
- + Level passage from living area to driver's cabin without tripping hazards
- + Electrically lowerable central fold-up bed\* above the seating area

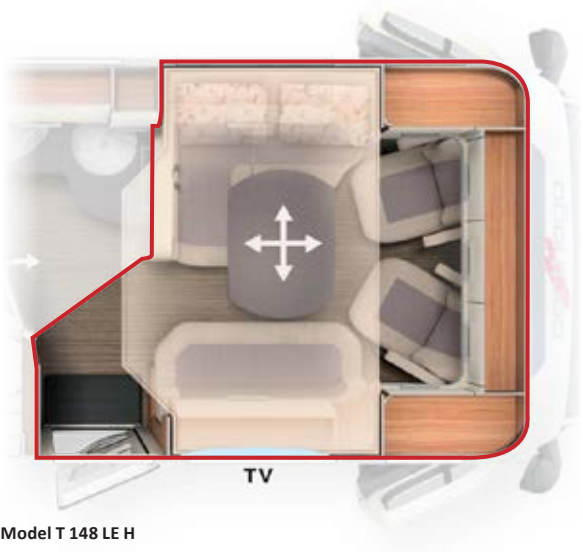

Model T 148 LE H

## Large L-shaped lounge seating area with long, lift-up side sofa

- + 360° living room table with chrome piping, rotatable using a foot pedal and movable in two directions
- + Exclusive lighting concept with LED technology, main light with numerous spotlights and separately switchable indirect ambient light
- + Swivel-out shoe cabinet with holding system for up to four pairs of shoes integrated into the plinth of the seat bench, including LED mood light
- + TV pull-out system "Quick up" behind side seat bench backrest for 32" LED flat screen\*
- + Easy storage compartment access without removing the upholstery via the seat bench cover of the L-shaped lounge seating area with patented fitting and lift-up side sofa
- + Level passage from living area to driver's cabin without tripping hazards
- + Electrically lowerable central fold-up bed\* above the seating area; free access to the XL habitation door, even with the central fold-up bed lowered





Elegantly integrated designer TV cabinet for 32" LED flat screen (T 143 LE)\*



TV pull-out system "Quick up" behind backrest (24" or 32", depending on model)\*



360° living room table, conveniently rotates and moves using a foot pedal



Swivel-out shoe cabinet with holding system for up to four pairs of shoes



L-shaped lounge seating area with "skyview" skylight with designer headliner above driver's cabin\* in casablanca world of style and Cambridge world of living

\* optional

# Kitchen highlights



## Space-saving galley kitchen

- + Kitchen units with six large drawers and separate waste bin in separate hygiene area
- + Designer overhead storage compartment with vertical waveform
- + Sink cover embedded flush in the surface, can be used as additional work surface/ chopping board
- + Raised kitchen worktop for visual room partitioning and as additional storage area
- + 133 l Slimtower fridge with door opening at both sides and separate freezer compartment
- + "Profi Gourmet" 3-ring hob with one-piece glass cover, robust cast iron trivet and easy-clean glass base
- + Capsule coffee maker with pull-out system\* in overhead storage cabinet with vertical waveform

Model T 143 LE



## Corner kitchen

- + Large work surface
- + Kitchen units with six large drawers and separate waste bin in separate hygiene area
- + Designer overhead storage compartment with vertical waveform
- + 153 l fridge with door opening at both sides and separate freezer compartment
- + Sink cover embedded flush in the surface, can be used as additional work surface/ chopping board
- + Raised kitchen worktop for visual room partitioning and as additional storage area
- + Indirect ambient lighting in plinth
- + "Profi Gourmet" 3-ring hob with divided glass cover, robust cast iron trivet and easy-clean glass base
- + Capsule coffee maker with pull-out system\* in overhead storage cabinet with vertical waveform

Model T 148 LE H



Space-saving galley kitchen (T 143 LE)



Six large drawers with separate waste bin in separate hygiene area



Capsule coffee maker with pull-out system\* in overhead storage cabinet with vertical waveform

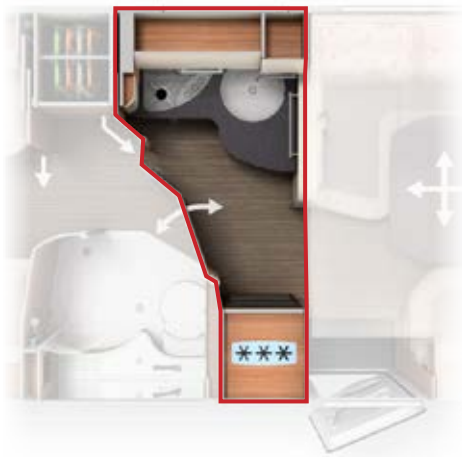

Model T 148 LE

### Corner kitchen

- + Large work surface
- + Kitchen units with six large drawers and separate waste bin in separate hygiene area
- + Designer overhead storage compartment with vertical waveform
- + 153 l fridge opposite with door opening at both sides and separate freezer compartment
- + Spice rack on kitchen wall
- + Sink cover embedded flush in the surface, can be used as additional work surface/ chopping board
- + Raised kitchen worktop for visual room partitioning and as additional storage area
- + Indirect ambient lighting in plinth
- + "Profi Gourmet" 3-ring hob with divided glass cover, robust cast iron trivet and easy-clean glass base
- + Capsule coffee maker with pull-out system\* in overhead storage cabinet with vertical waveform



Models T 149 LE, T 150 QB

### Comfort corner kitchen

- + Curved, extra large work surface, extended into the round washroom wall
- + Kitchen units with six large drawers and separate waste bin in separate hygiene area
- + Designer overhead storage compartment with vertical waveform
- + 153 l fridge opposite with door opening at both sides and separate freezer compartment
- + Spice rack on kitchen wall
- + Integrated bottle cabinet
- + Sink cover embedded flush in the surface, can be used as additional work surface/ chopping board
- + Raised kitchen worktop for visual room partitioning and as additional storage area
- + Indirect ambient lighting in plinth
- + "Profi Gourmet" 3-ring hob with divided glass cover, robust cast iron trivet and easy-clean glass base
- + Capsule coffee maker with pull-out system\* in overhead storage cabinet with vertical waveform



Corner kitchen with large work surface and spice rack (T 148 LE)



Comfort corner kitchen with curved, extra large worktop and integrated bottle cabinet (T 149 LE, T 150 QB)

\* optional

# Combined washroom with changing area

## Combined washroom model T 143 LE, T 148 LE, T 148 LE H

- + Practical comfort in a small space
- + Spacious round shower, completely separable via a lockable washroom door
- + Integrated shower shelf and towel rail in the Mini-Heki
- + Large mirrored storage cabinet with shelving arrangement and spacious wash stand base unit underneath
- + Mini-Heki skylight in washroom
- + Numerous shelves
- + Solid washroom door with interior hinges, metal handle and door lock

### Changing room with combined washroom, model T 143 LE with lengthways single beds

Room partitioning and a changing room are created in a single step.



The washroom door ① provides room partitioning from the living/sleeping areas and creates a private changing room at the same time.

### Changing room with combined washroom, model T 148 LE with lengthways single beds

Room partitioning and a changing room which is completely separate from the living/sleeping areas are created in three steps.

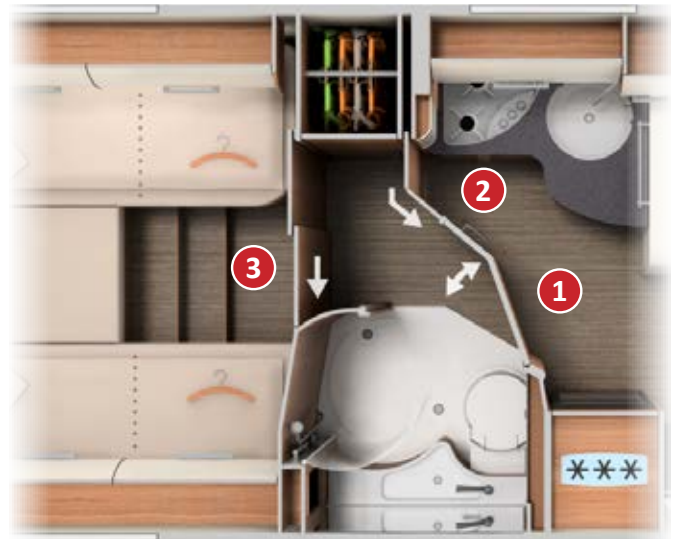

The washroom door ① and the pull-out room partition wall ② provide room partitioning from the living/sleeping areas and create a private changing room at the same time. The solid wood sliding door ③ in the sleeping area provides further room partitioning and therefore a completely separate changing room.



Combined washroom: Washing/toilet area with separable round shower



Private changing area thanks to washroom door

# Comfort luxury washroom with changing room

## Comfort luxury washroom models T 149 LE, T 150 QB

- + Spacious washroom/toilet with shower opposite
- + Waterproof shower insert in same design as living area floor, removable for showering (T 150 QB)
- + Large mirror storage cabinet and spacious wash stand base unit underneath
- + Mini-Heki skylight in washroom
- + Numerous shelves
- + Solid luxury washroom door with interior hinges, metal handle and door lock

## Changing room with comfort luxury washroom, model T 149 LE with lengthways single beds

Room partitioning and a changing room which is separated from the living/sleeping areas are created in just two steps.



The luxury washroom door **1** provides room partitioning from the living/sleeping areas and creates a private changing room at the same time. The solid wood sliding doors **2** in the sleeping area provide further room partitioning, and therefore a completely separate changing room.

Comfort luxury washroom with changing room separable from living area via lockable luxury washroom door and from sleeping area via solid wood sliding door (T 149 LE)

## Changing room with comfort luxury washroom, model T 150 QB with queen-size bed

Room partitioning and a changing room which is separated from the living/sleeping areas are created in just a few steps.

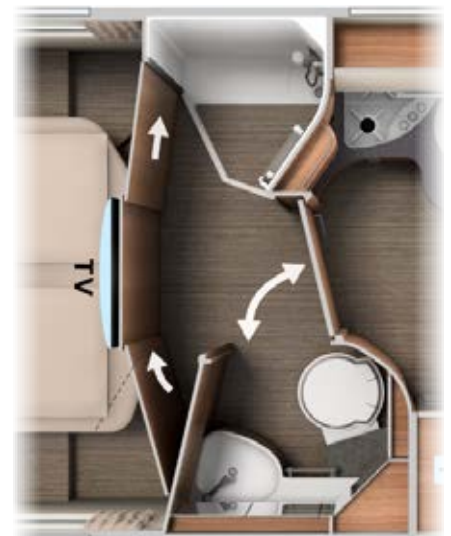
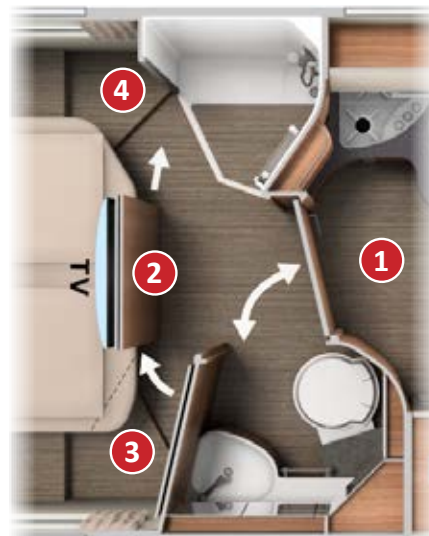
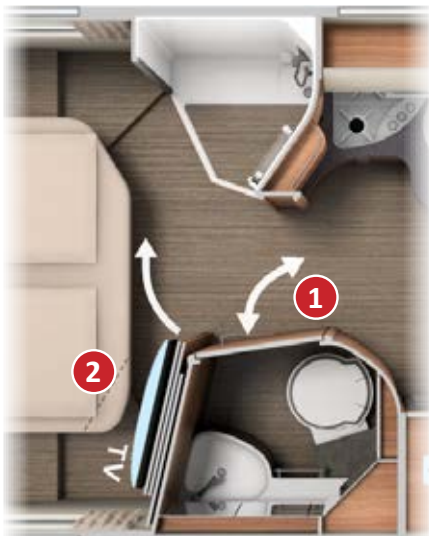

The luxury washroom door **1** provides room partitioning from the living/sleeping areas and creates a private changing room at the same time. The pull-out TV wall and the room partition **2** in the sleeping area provide further room partitioning and therefore a completely separable changing room.

The luxury washroom door **1** in the living/sleeping area room partitioning position. The pull-out TV wall and room divider **2** in the central position for relaxed viewing. The swivelling wall **3** and the pull-out sliding element **4** in the sleeping area provide further room partitioning and therefore a completely separate changing room.

Completely separate changing room with considerable freedom of movement, room partitioning from the living/sleeping areas including central TV position for comfortable viewing.

# Sleeping area highlights

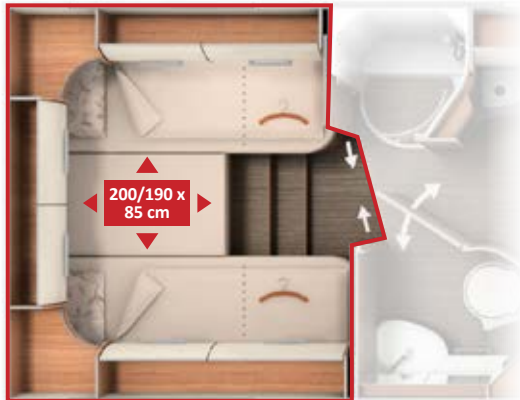

Models T 143 LE, T 148 LE, T 148 LE H, T 149 LE

## Lengthways single beds

- + Extra large sleeping areas up to 200 cm long with sleeping area extension between the beds with an additional mattress and adjustable head sections
- + Wardrobes beneath the lengthways single beds, conveniently accessible from the front and above via the lift function and the divided mattress (T 148 LE, driver side only)
- + Pull-out access steps for convenient access to the bed (T 143 LE)
- + Pull-out comfort access steps with extra-deep treads and additional storage compartment (optional for T 143 LE)
- + 7-zone quality cold foam mattress with breathable climate quilting
- + Two-part heated and ventilated slatted frame with flexibly supported wooden slats
- + Sleeping world & decoration set with decorative cushions, bed throw and fitted sheet set\*
- + 24" LED flat screen\* in rear for TV cabinet in bedroom



Model T 150 QB

## Queen-size bed

- + Extra large sleeping area with adjustable head section
- + Wardrobes on the left and right of the queen-size bed
- + Large drawer at front of queen-size bed
- + Fold-away mattress section at passenger side for extra-wide passage
- + Unique: Pull-out TV wall and room partition for partitioning off the washroom area
- + 7-zone quality cold foam mattress with breathable climate quilting
- + Two-part heated and ventilated slatted frame with flexibly supported wooden slats
- + Sleeping world & decoration set with decorative cushions, bed throw and fitted sheet set\*



24" LED flat screen\* for TV cabinet in sleeping area for lengthways single bed models



Fold-away mattress section at passenger side for extra-wide passage



Large lengthways single beds with raisable head section and pull-out comfort access steps. Convenient access to the wardrobes beneath the beds from the front and above thanks to lift function (T 148 LE, driver side only).



Queen-size bed with extra large sleeping area and raisable head section. There are wardrobes to the left and right of queen-size bed. Another large drawer is located at the front of the queen-size bed.

# Models & Highlights

## c-tourer Lightweight T 143 LE



AL-KO



Mercedes-Benz  
AL-KO



Patented<sup>(1)</sup>:  
Pull-out comfort  
access steps\*



## c-tourer Comfort T 148 LE



AL-KO

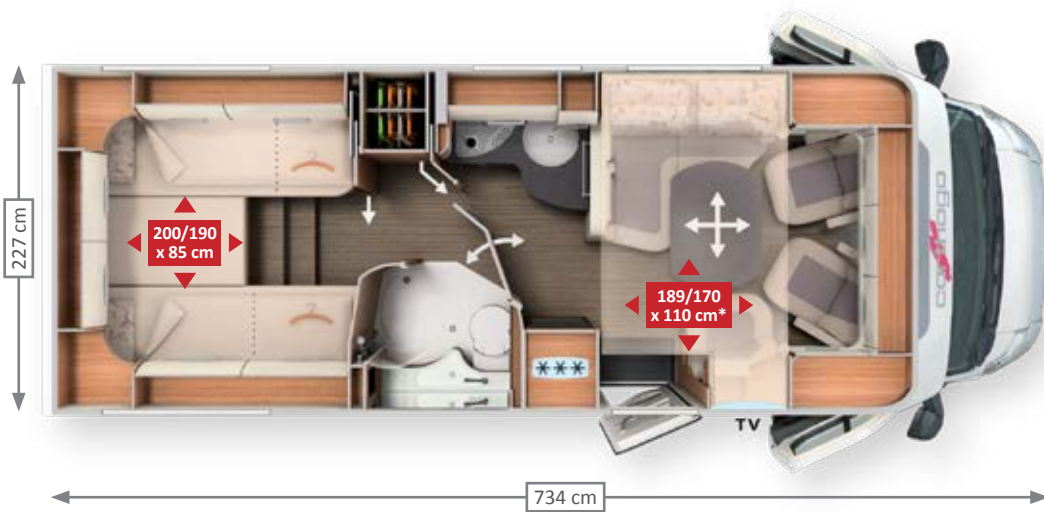

Patented<sup>(1)</sup>:  
Pull-out comfort  
access steps



## c-tourer Comfort T 148 LE H



AL-KO



Mercedes-Benz  
AL-KO

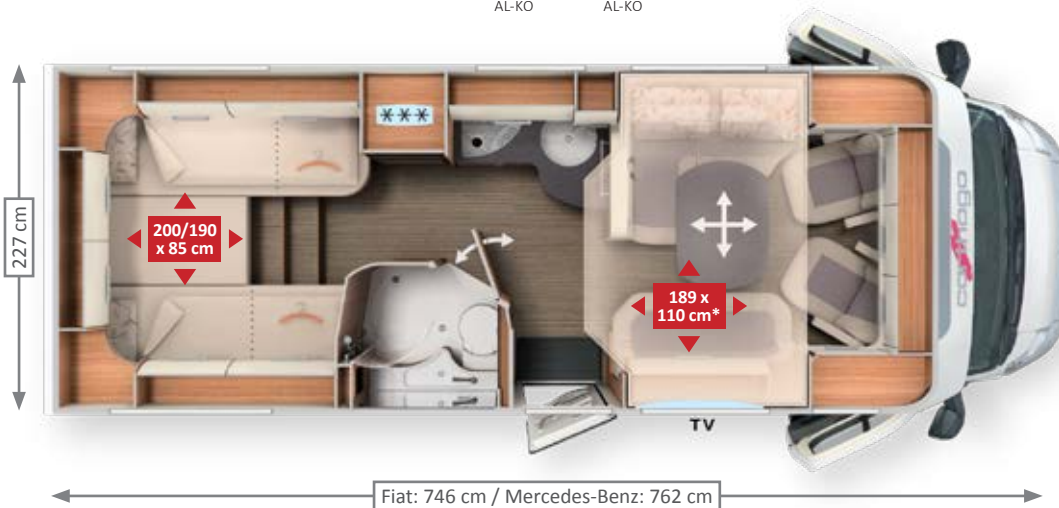

Patented<sup>(1)</sup>:  
Pull-out comfort  
access steps





- + All-rounder: lots of comfort, short vehicle length, light weight
- + Loadable up to 4.5 t\*
- + L-shaped lounge seating area with lift-up side seat bench
- + Compact galley kitchen
- + Raised kitchen worktop for visual room partitioning and as additional storage area
- + Combined washroom with round shower and practical towel rail in the Mini-Heki
- + Private changing area thanks to washroom door
- + Extra-large lengthways single beds with sleeping area up to 200 cm length
- + Wardrobes beneath lengthways single beds with extra-large interior height due to lowering into the double floor
- + Pull out steps for easy access to bed, optional pull-out comfort access steps with extra-deep treads and additional storage compartment
- + 24" LED flat screen\* in rear for TV cabinet in bedroom



Chassis	Weight ready to drive	Payload* up to	Seats with three-point seat belt	Berths
Fiat Ducato AL-KO low frame 35 light	2,935 kg	1,525 kg	4	2/3*
Mercedes-Benz Sprinter AL-KO low frame	3,015 kg	1,485 kg	4	2/3*

- + Comfort-oriented layout: Large L-shaped lounge seating area with wide, lift-up side seat bench
- + Electrically lowerable central fold-up bed above the seating area\*
- + Corner kitchen with large work surface and indirect ambient lighting in the floor plinth
- + Raised kitchen worktop for visual room partitioning and as additional storage area
- + Combined washroom with round shower, washroom door with room partitioning function and practical towel rail in the Mini-Heki
- + Completely separable changing room thanks to washroom door including pull-out partition wall and solid wood sliding door
- + Lengthways single beds up to 200 cm long with pull-out comfort access steps with extra-deep treads and additional storage compartment
- + Room-height wardrobe, additional wardrobes with extra-large interior height beneath the lengthways single beds
- + 24" LED flat screen\* in rear for TV cabinet in bedroom



Chassis	Weight ready to drive	Payload* up to	Seats with three-point seat belt	Berths
Fiat Ducato AL-KO low frame 35 light	3,045 kg	1,415 kg	4	2/4*

- + Comfort-oriented layout: large L-shaped lounge seating area with long side seat bench
- + Electrically lowerable central fold-up bed above the seating area\*; free access to the XL habitation door, even with the central fold-up bed lowered
- + Corner kitchen with large work surface and indirect ambient lighting in the floor plinth
- + Raised kitchen worktop for visual room partitioning and as additional storage area
- + Combined washroom with round shower and practical towel rail in the Mini-Heki
- + Lengthways single beds up to 200 cm long with pull-out comfort access steps with extra-deep treads and additional storage compartment
- + Wardrobes beneath lengthways single beds with extra-large interior height due to lowering into the double floor
- + 24" LED flat screen\* in rear for TV cabinet in bedroom



Chassis	Weight ready to drive	Payload* up to	Seats with three-point seat belt	Berths
Fiat Ducato AL-KO low frame 35 light	3,025 kg	1,435 kg	4	2/5*
Mercedes-Benz Sprinter AL-KO low frame	3,105 kg	1,395 kg	4	2/5*

\* optional

# Models & Highlights

## c-tourer Comfort T 149 LE

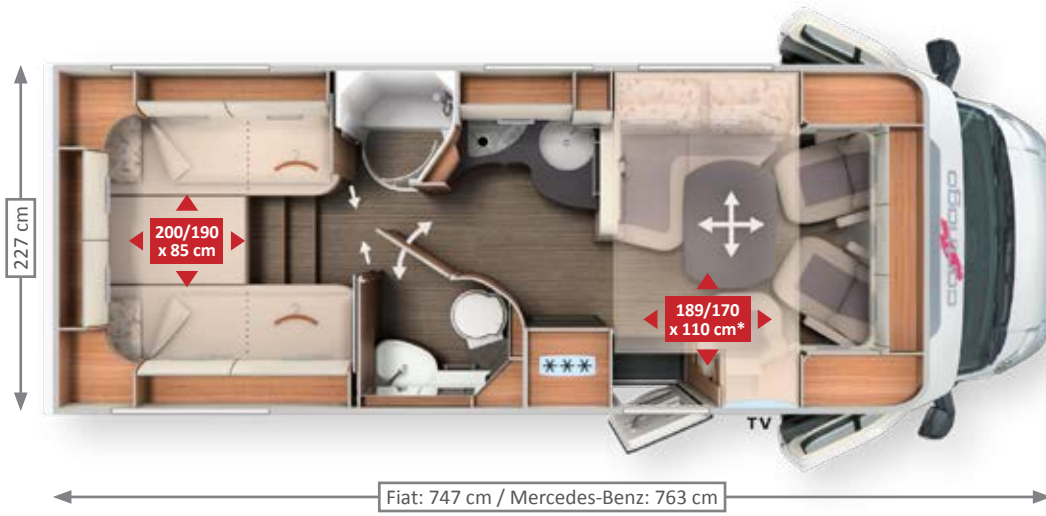

**Patented<sup>(1)</sup>:**  
Pull-out comfort access steps

## c-tourer Comfort T 150 QB

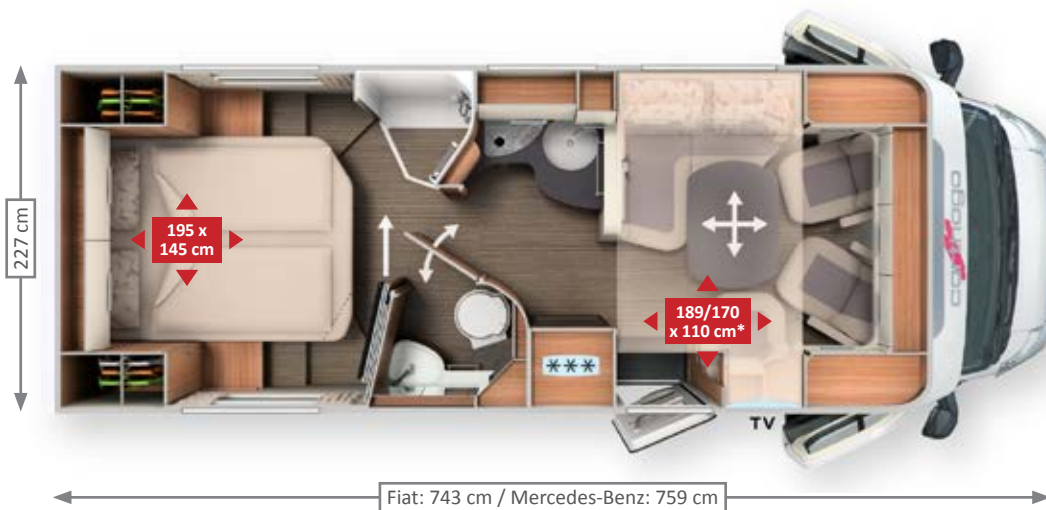

**Patented<sup>(1)</sup>:**  
Pull-out TV wall and room divider;  
Pedelec scooter garage\*

- + Comfort-oriented layout: Large L-shaped lounge seating area with wide, lift-up side seat bench
- + Electrically operated central drop-down bed with wide sleeping area for two persons\*
- + Comfort corner kitchen with large work surface and indirect ambient lighting in the floor plinth
- + Raised kitchen worktop for visual room partitioning and as additional storage area
- + Comfort luxury washroom with spacious washing/toilet room and shower opposite
- + Completely separable changing room thanks to luxury washroom door and solid wood sliding doors
- + Lengthways single beds up to 200 cm long with pull-out comfort access steps with extra-deep treads and additional storage compartment
- + Wardrobes beneath lengthways single beds with extra-large interior height due to lowering into the double floor
- + 24" LED flat screen\* in rear for TV cabinet in bedroom



Chassis	Weight ready to drive	Payload* up to	Seats with three-point seat belt	Berths
Fiat Ducato AL-KO low frame 35 light	3,035 kg	1,425 kg	4	2/4*
Mercedes-Benz Sprinter AL-KO low frame	3,115 kg	1,385 kg	4	2/4*

- + Comfort-oriented layout: Large L-shaped lounge seating area with wide, lift-up side seat bench
- + Electrically operated central drop-down bed with wide sleeping area for two persons\*
- + Comfort corner kitchen with large work surface and indirect ambient lighting in the floor plinth
- + Raised kitchen worktop for visual room partitioning and as additional storage area
- + Comfort luxury washroom with spacious washing/toilet room and shower opposite
- + Completely separable changing room thanks to luxury washroom door and pull-out TV wall and room divider
- + Large queen-size bed, convenient bed access, comfortable sleeping width as far as the foot area
- + Two wardrobes at each side of the bed
- + Two large drawers at the front of the queen-size bed
- + Fold-away mattress section at passenger side for extra-wide passage



Chassis	Weight ready to drive	Payload* up to	Seats with three-point seat belt	Berths
Fiat Ducato AL-KO low frame 35 light	3,035 kg	1,425 kg	4	2/4*
Mercedes-Benz Sprinter AL-KO low frame	3,115 kg	1,385 kg	4	2/4*

# Exterior



AL-KO



Mercedes-Benz

AL-KO

## Standard white

Habitation, vehicle front, front, side and rear skirtings and wheel arches in white



Fiat Ducato



Mercedes-Benz Sprinter

Subject to differences in the colour scheme or individual colour shades, differences in material characteristics and changes to the scope of delivery on the part of the manufacturer. This also applies to colour differences on basic vehicles, insofar as they are a result of changes made by the basic vehicle manufacturer.

## Driver's cabin design

### Fiat Ducato driver's cabin

Standard version with all-round overhead storage cabinets, with Barcelona (23) world of living



### Mercedes-Benz Sprinter driver's cabin

Standard version with all-round overhead storage cabinets, with Cambridge world of living



3.5t

# Carthago lightweight construction technology

2,935 KG



c-tourer  
Lightweight | Comfort

## Down with the weight, up with the quality

Specially for the 3.5 t weight class

Extremely stable and super light: Carthago is the pioneer for intelligent lightweight construction throughout the industry. Carthago reduces the weight, but not the customary comfort or quality. The Carthago c-tourer T 143 LE Lightweight is the lightest model in its class – with maximum stability, quality, maximum comfort and a comprehensive range of equipment. The consistent lightweight construction technology has many benefits: More payload, lower fuel consumption and fewer emissions at the same time.



### Your added value

- + **Outstanding manoeuvrability and less weight** due to short vehicle length
- + **More payload** also in the 3.5 t weight class
- + **Lower fuel consumption**
- + **Class B driver's license sufficient**
- + **Fewer restrictions** because of road traffic regulations
- + **Fewer toll charges**

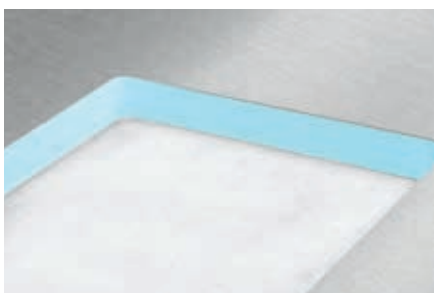

Carthago main body construction technology: thanks to the combination of aluminium on the outside and the inside and the RTM hard foam insulating core which are typical of the brand, weight-intensive wall reinforcements can be dispensed with



Maximum stability and torsional rigidity thanks to the Carthago double floor with self-supporting body and AL-KO low frame special



thanks to the piping technology, the curved and rounded moulded furniture parts provide high stability and less weight at the same time

# Double floor with huge storage compartment

EASY ENTRY – convenient loading from the outside, easy removal from the inside



Usable height  
up to 55.5 cm

## PASSENGERS SIDE



● Gas bottle compartment



Scooter garage with large interior height thanks to deep lowering, with access from both sides via two large scooter garage doors at the driver and passenger sides



Load from the outside

Convenient loading of the double floor storage compartment via a large external hatch



Unload from the inside

Easy removal of the storage compartment contents from the inside via the lift-up seat bench cover of the L-shaped lounge seating area with patented fitting



Additional double floor storage compartments

Living area floor hatch with double floor storage box (42 cm usable depth) in heated double floor

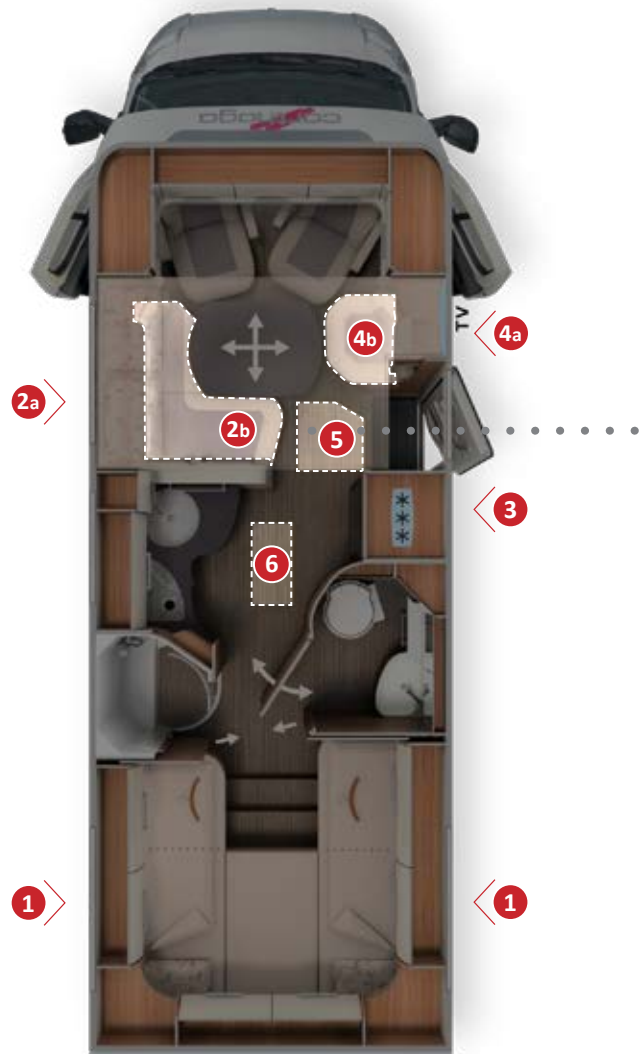



## Your added value

- + **Double floor** with huge, heated storage compartment, usable height up to **55.5 cm**
- + **Exterior access** via several large hatches
- + Convenient **interior access** via L-shaped lounge seating area seat bench cover, lift-up side seat bench and the large living area floor hatch
- + **Large, central through-loading space** (interior height 22 cm), with extra-low double floor storage compartment (usable height 46 cm), convenient loading also through XL habitation door via large, self-supporting living area floor hatch
- + The entire double floor is heated with a **climate storage function** and underfloor heating effect

DRIVERS SIDE



Large, additional double floor storage compartment with separate exterior hatch



Convenient loading of the double floor storage compartment via a large external hatch\*

Load from the outside



Large living area floor hatch in the entrance area: also easy to load from the outside with the XL habitation door open



Convenient removal of contents via the lift-up side seat bench\*

Unload from the inside

\* depending on model

# On-board equipment

Electrical equipment, water supply, warm air storage heating system



## Warm air storage heating system

Truma Combi 6



## Optional:

Alde warm water heating\*



## Double floor

with climate storage function  
and underfloor heating effect



## Capacity

150 l fresh water tank  
140 l waste water tank  
1 x 80 Ah gel battery  
(extendible to 2 x 80 Ah)

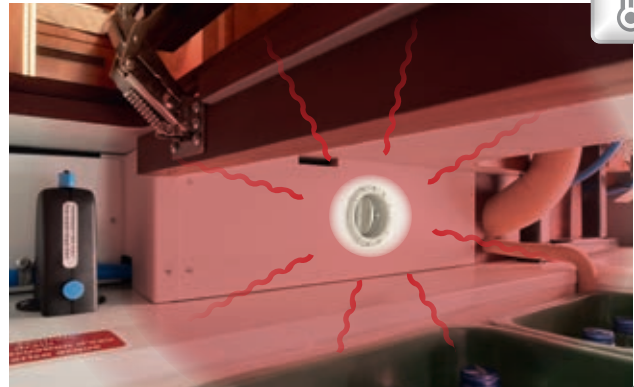

## Truma Combi 6 warm air storage heating system

with numerous warm air outlets throughout the double floor, the living area, the scooter garage and the cold-sensitive door entrances



## "easy change" gas bottle compartment

extra low for convenient bottle changing, both bottles individually accessible  
(not T 143 LE)



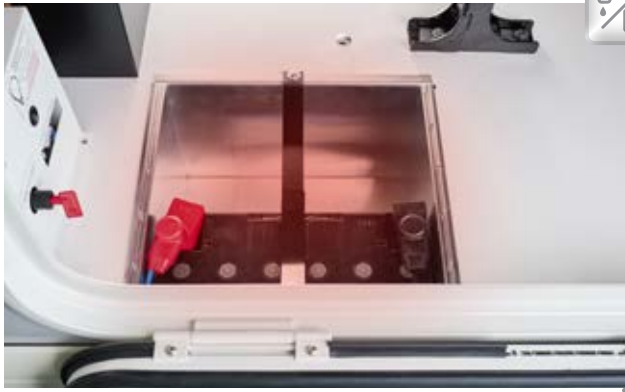

**Heated battery centre**

with main battery switch; Standard: Gel batteries 1 x 80 Ah, extendible to 2 x 80 Ah, optional 90 Ah lithium-ion battery including battery computer and separate touch display



**Electrical centre**

easily accessible in scooter garage

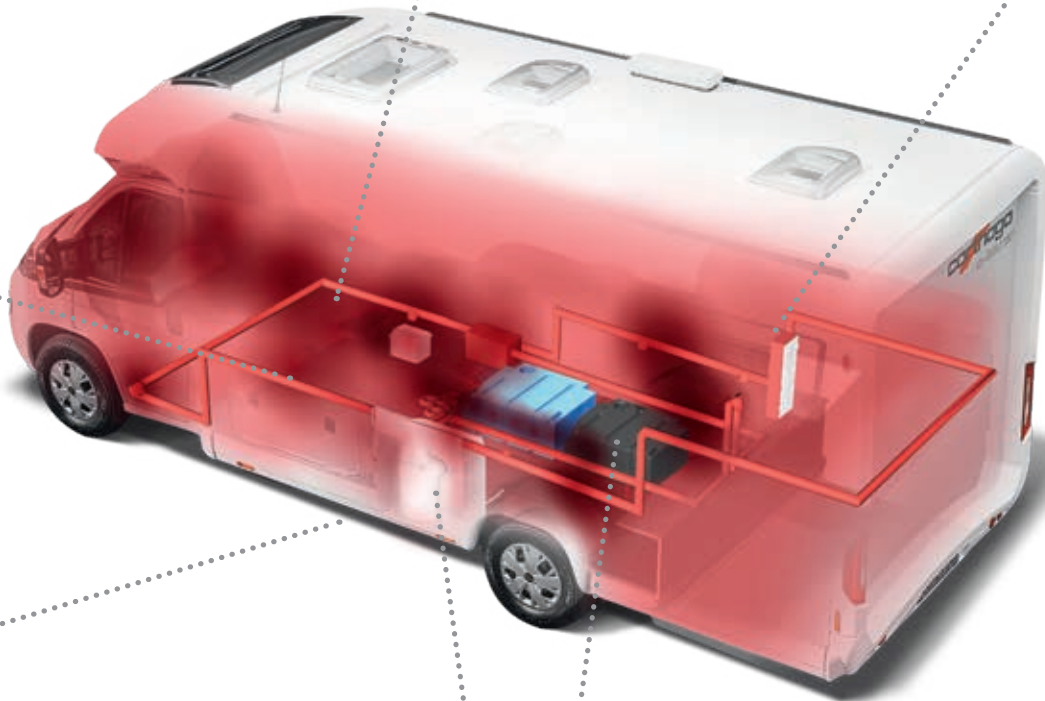

**Gas bottle compartment**

with separate exterior door (T 143 LE). Optional: comfort gas bottle pull-out system

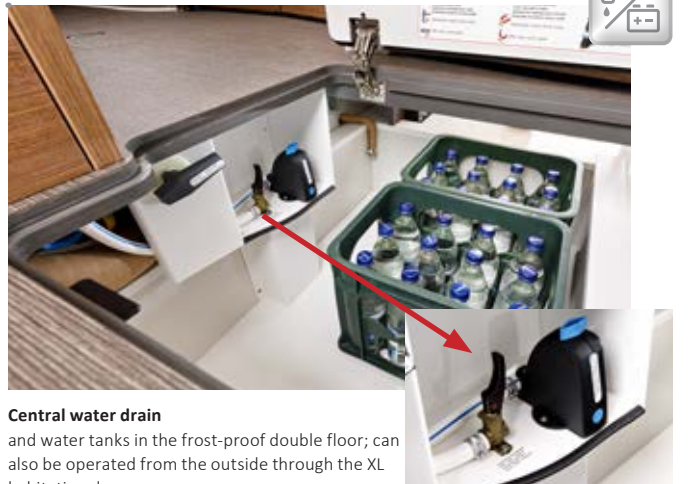

**Central water drain**

and water tanks in the frost-proof double floor; can also be operated from the outside through the XL habitation door

# Standard features

## AL-KO low frame special light



with light weight and passenger car-like driving comfort

## XL habitation door "premium two 2.0"



with widened passage size of 63 cm, secure double locking, extra-wide door window, pleated blackout blind and integrated insect screen roller blind

## Central locking



using hand transmitter in the main key for the drivers cabin doors

## Driver's cabin pilot seats



with upholstered, adjustable armrests

## Exterior hatches and doors



with interior hinges, integrated flat in the body

## All-round overhead storage cabinets



provides a tremendous amount of storage space in the driver's cabin area

### Designer overhead storage compartment



with optional coffee machine pull-out system

### Ambient floor plinth underlighting



in the living and kitchen area (not T 143 LE)

### Spice rack



design element and practical detail at the same time – secure storage for spices in the kitchen area (T 148 LE)

### Stepless, continuous floor in living area



from driver's cabin to the sleeping area

### Exclusive lighting concept with LED lighting technology



with separately controlled, indirect ambient lighting and main light with numerous spotlights

### Ergonomically shaped seat upholstery



with multi-layer premium foam core and stylish front panel



AL-KO



Mercedes-Benz

AL-KO

# chic c-Line

## The fascination of the Carthago premium class

### Elegance, comfort and extravagance

Luxurious, extravagant, comfortable and thoroughly practical at the same time: the chic c-line T comes up trumps with regard to payload, storage space, top class driving comfort, modern design and pure living comfort. Its charm sets the chic c-line T apart from the wide range of coachbuilt vehicles that are available on the market.

Available on the Fiat Ducato AL-KO and the Mercedes-Benz Sprinter AL-KO.



#### Weight class

- + Comfort-oriented floor plans up to a permissible gross vehicle weight of 4.5 t



AL-KO



Mercedes-Benz  
AL-KO

#### Chassis

- + Fiat Ducato 40 heavy or Mercedes-Benz Sprinter 414 CDI\*, special Carthago AL-KO low frame with 198 cm wide wheelbase rear-axle
- + Fiat Ducato safety package as standard: Airbag, ESP, ABS, ASR, electronic immobiliser, Hillholder, Traction Plus, Hill Descent Control, automatic start/stop, cruise control, side wind assistant, stability control for trailer, collision braking system/Mercedes-Benz Sprinter safety package as standard: Airbag, side wind assistant, Hillholder, ABS, ASR, EBV, ESP
- + Optional: Fiat driver's assistance package
- + XL habitation door "premium two 2.0" with wider entrance size of 63 cm, secure double locking and extra-wide door window



#### Living comfort

- + "Exclusiveline" furniture design, flowing stylistic features, rounded, exclusive furniture finishes, choice of two worlds of style
- + Stepless, continuous floor in living area
- + L-shaped lounge seating area with ergonomically designed upholstery, wide side seat bench and 360° rectangular living area table with chrome piping
- + Comfort corner kitchen with six large drawers, elevated kitchen work surface with designer bar cabinet as visual room divider and additional work area, slide-out storage cabinet
- + Comfort luxury washroom: Maximum comfort with completely separable changing room
- + Fixed beds with point-elastic Carawinx sleeping system



#### Storage space

- + Double floor with huge heated storage compartment, usable height up to 70 cm



- + Exterior access via several large hatches, convenient access from the inside via the seat bench cover of the L-shaped lounge seating area and the lift-up side seat bench
- + Large, central through-loading space (interior height 22 cm), with extra-low double floor storage compartment (usable height 46 cm), convenient loading from the inside and outside via a large, self-supporting living area floor hatch
- + Scooter garage: interior height up to 120 cm\*, loadable up to 350 kg



#### Self-sufficiency/equipment

- + 170 l fresh water/140 l waste water
- + 2 x 80 Ah gel battery



#### Air conditioning/heating

- + Truma Combi 6 warm air storage heating system, optional Alde warm water heating
- + Double floor with underfloor heating effect



All chic c-line models are also available on the Fiat Ducato with AL-KO low frame chassis – see model overview and price list!



\* depending on model

# linea moderna world of style as standard

Ivory part leather world of living | picture shows T 4.9 LE





# Optional linea progressiva world of style

Macchiato part leather (23) world of living | picture shows T 4.9 LE







# chic c-line T 4.9 LE

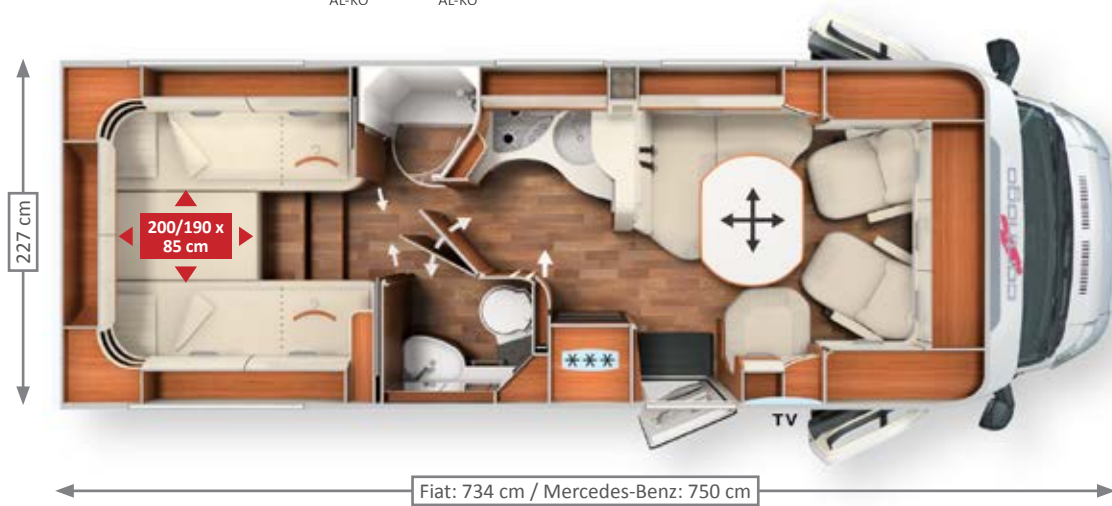

**Patented<sup>(1)</sup>:**  
 Luxury washroom door with 3 way function;  
 Pull-out comfort access steps

chic c-line



### Large L-shaped lounge seating area with wide side seat bench

- + 360° living room table with chrome piping, rotatable using a foot pedal and movable in two directions
- + "Quick up" TV pull-out system incl. 24" LED flat screen\* behind side seat bench backrest
- + Swivel-out shoe cabinet with holding system for up to four pairs of shoes integrated into the plinth of the seat bench, including LED mood light
- + Easy storage compartment access via the seat bench cover without removing the upholstery of the L-shaped lounge seating area and the lift-up side seat bench
- + Exclusive lighting concept in LED light technology with dimming function, main light with numerous spotlights and indirect ambient light, separately controllable
- + "Skyview" skylight with designer headliner above driver's cabin\*



### Comfort luxury washroom with changing room

- + Spacious washroom/toilet
- + Shower opposite, shower doors finished off with high quality chrome profiles
- + Waterproof shower inlay, removable for cleaning
- + Spacious mirror and wash stand base unit
- + Completely separate changing area via the luxury washroom door with 3-way- function thanks to double door and sliding doors made from solid wood



### Large lengthways single beds

- + Extra large sleeping areas up to 200 cm long with sleeping area extension between the beds with an additional mattress and raisable head sections
- + Carawinx sleeping system – medically recommended, point-elastic under springing system
- + Wardrobes beneath the lengthways single beds, easily accessible from front and above via the lift function – lowered into the double floor for additional interior height
- + Convenient access via pull-out comfort access steps with additional storage compartment
- + 7-zone quality cold foam mattresses with breathable climate quilting
- + Designer shelves in sleeping area
- + 24" LED flat screen\* in rear for TV cabinet in bedroom



### Comfort corner kitchen

- + Elevated kitchen work surface with designer bar cabinet as visual room divider and additional work area
- + Pull-out system with capsule coffee maker at side of bar cabinet for convenient access
- + Elegantly curved work surface with spice rack on kitchen wall, extended sideways as far as the round washroom wall
- + Separate bottle cabinet
- + "Profi Gourmet" 3-ring hob with divided glass cover, robust cast iron trivet and easy-clean glass base
- + Six large drawers and separate waste container in separate hygiene area
- + 153 l fridge with door that opens at both sides and separate freezer compartment
- + Sink cover as additional work area/chopping board
- + Slide-out storage cabinet integrated in round washroom wall
- + Indirect ambient lighting in plinth

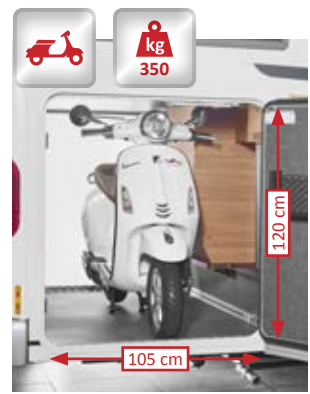

Chassis	Weight ready to drive	Payload* up to	Seats with three-point seat belt	Berths
Fiat Ducato AL-KO low frame 40 heavy	3,345 kg	1,155 kg	4	2/3*
Mercedes-Benz Sprinter AL-KO low frame DA	3,385 kg	1,115 kg	4	2/3*



L-shaped lounge seating area with "skyview" skylight with designer headliner above driver's cabin\* in linea moderna world of style and ivory part leather world of living



"Quick up" TV pull-out system\* behind backrest



Comfort corner kitchen with raised kitchen work surface with designer bar cabinet as visual room divider and additional work surface



Wardrobes beneath the lengthways single beds with extra-large interior height



Comfort luxury washroom with shower opposite and completely separate changing room



Large lengthways single beds with pull-out comfort access steps

\* optional

# chic c-line T 5.0 QB



**Patented<sup>(1)</sup>:**  
 Luxury washroom door with 3 way function;  
 Pull-out TV wall and room divider;  
 Pedelec scooter garage\*

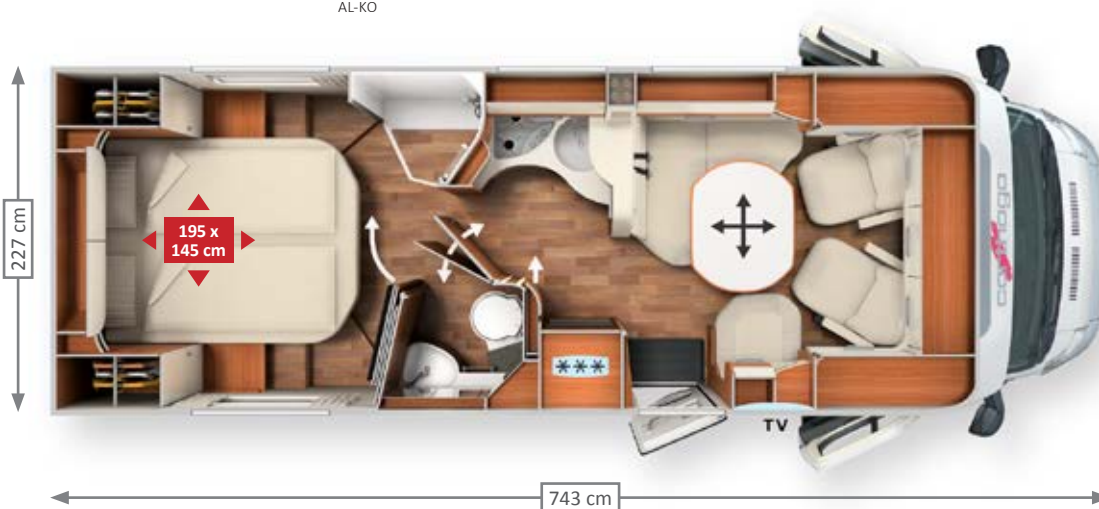

chic c-line



## Large L-shaped lounge seating area with wide side seat bench

- + 360° living room table with chrome piping, rotatable using a foot pedal and movable in two directions
- + "Quick up" TV pull-out system incl. 24" LED flat screen\* behind side seat bench backrest
- + Swivel-out shoe cabinet with holding system for up to four pairs of shoes integrated into the plinth of the seat bench, including LED mood light
- + Easy storage compartment access via the seat bench cover without removing the upholstery of the L-shaped lounge seating area and the lift-up side seat bench
- + Exclusive lighting concept in LED light technology with dimming function, main light with numerous spotlights and indirect ambient light, separately controllable



## Comfort luxury washroom with changing room

- + Spacious washroom/toilet
- + Shower opposite
- + Shower doors finished off with high quality chrome profiles
- + Waterproof shower inlay, removable for cleaning
- + Washroom with numerous storage areas
- + Spacious mirror and wash stand base unit
- + Completely separable changing area via the luxury washroom door with 3-way- function thanks to double door and pull-out TV wall and room divider



## Comfort corner kitchen

- + Elevated kitchen work surface with designer bar cabinet as visual room divider and additional work area
- + Pull-out system with capsule coffee maker at side of bar cabinet for convenient access
- + Elegantly curved work surface with spice rack on kitchen wall, extended sideways as far as the round washroom wall
- + Separate bottle cabinet
- + "Profi Gourmet" 3-ring hob with divided glass cover, robust cast iron trivet and easy-clean glass base
- + Six large drawers and separate waste container in separate hygiene area
- + 153 l fridge with door that opens at both sides and separate freezer compartment
- + Sink cover as additional work area/chopping board
- + Slide-out storage cabinet integrated in round wash-room wall
- + Indirect ambient lighting in plinth



## Large queen-size bed

- + Extra large sleeping area with adjustable head section
- + Carawinx sleeping system – medically recommended, point-elastic under springing system
- + Two wardrobes at each side of the queen-size bed
- + Two large drawers at the front of the queen-size bed
- + Unique: Pull-out TV wall and room partition for partitioning off the washroom area. TV wall in central position or at passenger side for relaxed viewing
- + 7-zone quality cold foam mattresses with breathable climate quilting



Chassis	Weight ready to drive	Payload* up to	Seats with three-point seat belt	Berths
Fiat Ducato AL-KO low frame 40 heavy	3,345 kg	1,155 kg	4	2/3*



Pull-out system incl. capsule coffee maker\*



"Quick up" TV pull-out system\* behind backrest



Two large drawers at front of queen-size bed



Comfort corner kitchen with raised kitchen work surface with designer bar cabinet as visual room divider and additional work surface



Comfort luxury washroom with shower opposite and completely separate changing room



Pull-out TV wall and room divider in central TV position

\* optional

# Exterior



AL-KO SA/DA AL-KO SA/DA

## Standard white

Habitation, driver's cabin white; front, side and rear skirts silver/platinum



Fiat Ducato



Mercedes-Benz Sprinter



Fiat Ducato front design

Mercedes-Benz Sprinter front design

Fiat Ducato rear design

Mercedes-Benz Sprinter rear design

Subject to differences in the colour scheme or individual colour shades, differences in material characteristics and changes to the scope of delivery on the part of the manufacturer. This also applies to colour differences on basic vehicles, insofar as they are a result of changes made by the basic vehicle manufacturer.

# Driver's cabin design

## Fiat Ducato driver's cabin

Standard version with all-round overhead storage cabinets, with ivory part leather world of living



## Mercedes-Benz Sprinter driver's cabin

Standard version with all-round overhead storage cabinets, with ivory part leather world of living



# Double floor with huge storage compartment

EASY ENTRY – convenient loading from the outside, easy removal from the inside



Usable height up to 70 cm

PASSENGERS SIDE



Gas bottle compartment



Scooter garage, load capacity up to 350 kg

Scooter garage with interior height of up to 120 cm thanks to deep lowering, with access from both sides via two large scooter garage doors at the driver and passenger sides

chic c-line



Load from the outside

Convenient loading of the double floor storage compartment via a large external hatch

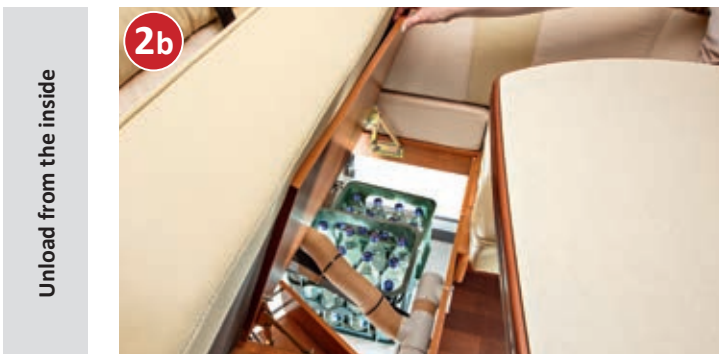

Unload from the inside

Easy removal of the storage compartment contents from the inside via the lift-up seat bench cover of the L-shaped lounge seating area with patented fitting



Additional double floor storage compartments

Living area floor hatch with double floor storage box (42 cm usable depth) in heated double floor

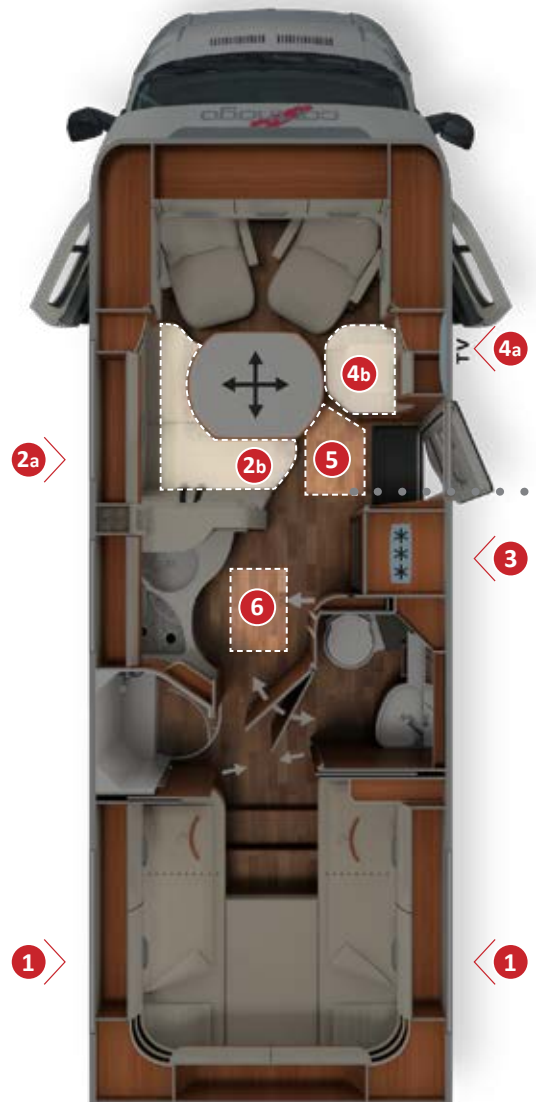





## Your added value

- + **Double floor** with huge, heated storage compartment, usable height up to 70 cm
- + **Exterior access** via several large hatches
- + Convenient **interior access** via the L-shaped lounge seating area seat bench cover, hinged side seat bench and the large living area floor hatch
- + **Large, central through-loading space** (interior height 22 cm), with extra-low double floor storage compartment (usable height 46 cm), convenient loading also through XL habitation door via large, self-supporting living area floor hatch
- + The entire double floor is heated with a **climate storage function** and underfloor heating effect

DRIVERS SIDE



Large, additional double floor storage compartment with separate exterior hatch



Convenient loading of the double floor storage compartment via a large external hatch

Load from the outside



Large living area floor hatch in the entrance area: also easy to load from the outside when the XL habitation door is open



Convenient removal of contents via lift-up side seat bench

Unload from the inside

# On-board equipment

Electrical equipment, water supply, warm air storage heating system



**Warm air storage heating system**  
Truma Combi 6



**Optional:**  
ALDE warm water central heating



**Double floor**  
with climate storage function and  
underfloor heating effect



**Capacity**  
170 l fresh water tank  
140 l waste water tank  
2 x 80 Ah gel battery

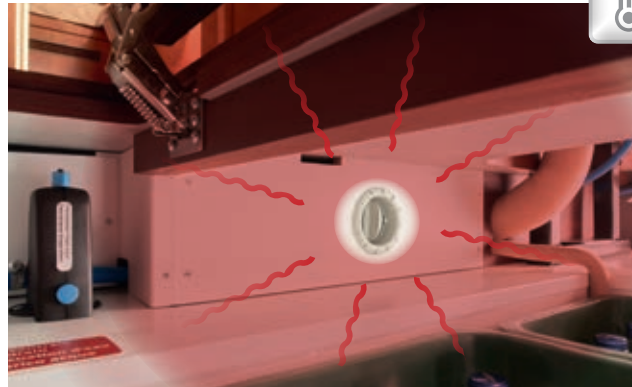

**Truma Combi 6 warm air storage heating system**  
with numerous warm air outlets throughout the double floor, the living area, the scooter garage and the cold-sensitive door entrances



**"easy change" gas bottle compartment,**  
extra-low for convenient bottle changing



**Heated battery centre**  
with main power switch. Standard: Gel batteries 2 x 80 Ah, positioned in exterior storage space on passenger side for easy access, optional Lithium ion battery, 90 Ah including battery computer and separate touch display



**Electrical centre**  
easily accessible in scooter garage

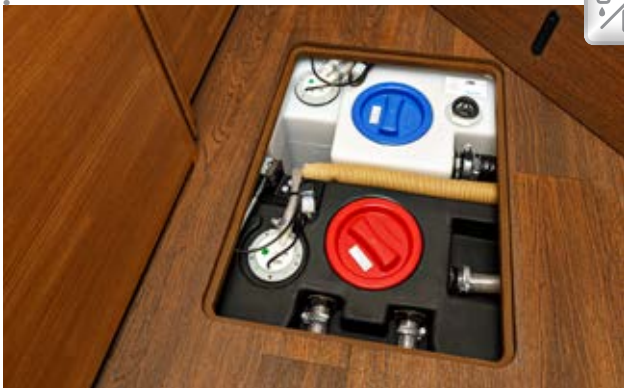
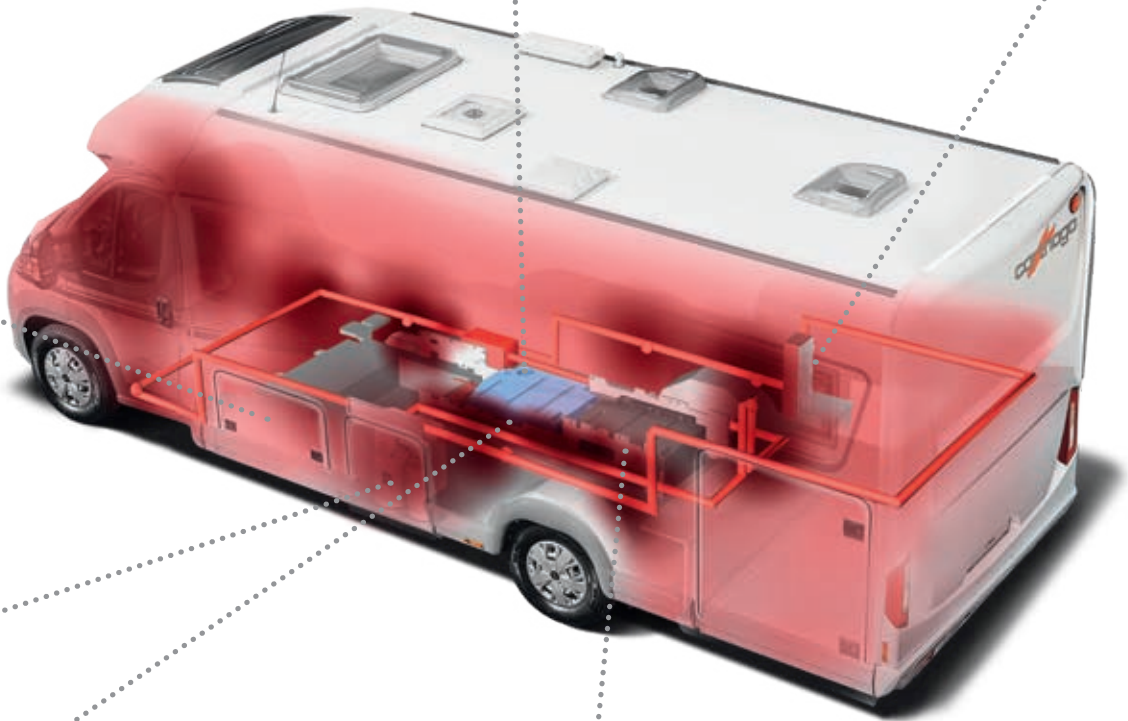

**Water tanks**  
frostproof in heated double floor



**Central water drain**  
can also be operated from the outside through the XL habitation door



# Standard features

## AL-KO low frame special

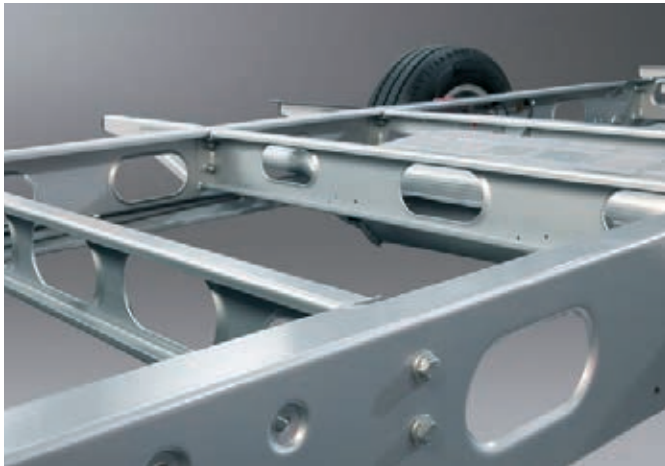

light weight, passenger car-like driving comfort, fully galvanized

## “Coming Home” function



with remote control in main key for simultaneous activation of central locking and exterior lighting

## XL habitation door “premium two 2.0”



with widened passage size of 63 cm, security double locking, extra-wide door window, pleated blackout blind and integrated insect screen roller blind

## Driver’s cabin pilot seats



with padded armrests at both sides, multiple adjusting facilities, sitting height at lounge seating area level in living configuration

## Stepless, continuous floor in living area



from driver’s cabin to the sleeping area

## Swivel-out shoe cabinet



with holding system for up to four pairs of shoes integrated into the plinth of the seat bench

**Exclusive lighting concept with LED lighting technology**



with dimming function, main light with numerous spotlights and indirect ambient light, separately controllable

**360° living area table**



with chrome piping, rotatable using a foot pedal and movable in two directions

**Ergonomically shaped seat upholstery**



with multi-layer premium foam core and stylish front panel

**“Profi Gourmet” 3-ring hob**



with divided glass cover, robust cast iron trivet and easy-clean glass base

**Slide-out storage cabinet**



practical storage compartment with convenient access at hand height

**Carawinx sleeping system**



with medically recommended, point-elastic under-springing system, 7-zone quality cold foam mattress and adjustable head section

# Worlds of living

## Large selection – the upholstery collections from Carthago

Collection	c-tourer		chic c-line	
	epic	casablanca	linea moderna	linea progressiva
World of style				
Antara fabric	Barcelona (23)	●	●	●
	Venezia	●	●	●
	Cambridge	●	●	-
	Rome	●	●	-
Textile leather / fabric	Malaga	○	○	○
	Davos	○	○	○
Part leather	Ivory part leather	○	○	○
	Macchiato part leather (23)	○	○	○
	Ivory Supreme part leather	-	-	○
	Sand Supreme part leather	-	-	○
Leather	Ivory leather	○	○	○
	Sand leather	○	-	○
	Macchiato leather	○	○	○

● Standard equipment   ○ Optional equipment   - Not available depending on model

### Your added value

- + **Highly effective stain protection**  
Fluids do not penetrate into the fabric, so the majority of stains can be easily wiped off with a damp cloth
- + **Excellent anti-fade properties**
- + **Hard-wearing and easy to look after**
- + **Washable curtains and decorative cushion covers**
- + **Antibacterial mattress cover**



Highly effective stain protection systems protect your upholstery

# Upholstery design

## c-tourer Lightweight | c-tourer Comfort



The seating areas of the c-tourer series emanate sporty lightness with their dynamic contrasting inserts. This is emphasised by the modern double-stitched seams, which underline our high quality feel. These double-stitched seams are in a contrasting colour in the Sand leather and Macchiato leather collections. In the Malaga collection, elegant contrasts are provided by piping.

## chic c-line



The seating areas of the chic c-line model series create an elegant living room atmosphere. Piping or high-quality double-stitched seams are used as style elements at the edges of the upholstery. In the Sand leather and Macchiato leather collections, these double-stitched seams are in a contrasting colour and combined with piping in the same colour. In the "Malaga" collection, contrast is provided by piping and an additional stripe. The Part leather supreme collections combine the most sophisticated materials from well-known Hitex® manufacturer "Rohleder" with fine leather. For high-end premium leather options in our vehicles, we have the Performance collections, which impress in the manufacturing style with their elaborately quilted leather inserts.

# Worlds of living\*

## Very high quality Antara / fabric combination:

Antara with highly effective "Teflon Repel" stain protection, contrasting fabric with dirt-repellent stain protection

Barcelona (23)



Venezia



Cambridge



Rome



## Very high quality textile leather / fabric combination:

extremely hard-wearing textile leather in soft Nappa quality, contrasting fabric with dirt-repellent stain protection

Malaga



Davos





**Very high quality leather / fabric combination:**

leather with outstanding quality, contrasting fabric with dirt-repellent stain protection

Ivory part leather



Macchiato part leather (23)



Ivory Supreme part leather

**ROHLEDER**  
DIE HITEX MANUFAKTUR



Sand Supreme part leather

**ROHLEDER**  
DIE HITEX MANUFAKTUR

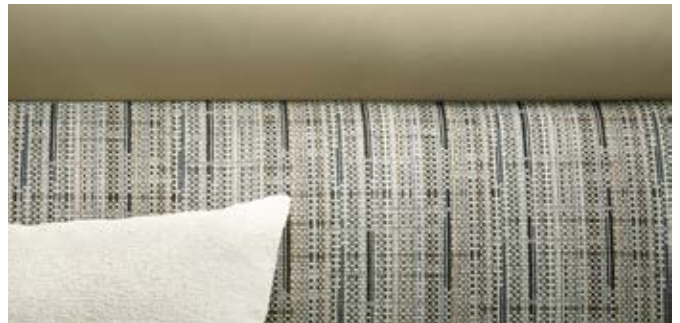

**Very high quality leather finish:**

classy combination of leather with outstanding quality

Ivory leather



Sand leather



Macchiato leather



# The Carthago Premium DNA

## More than a good feeling

Innovative thinking, an eye for detail, extravagant solutions and consistent development focus on a high degree of practical use, the perfect combination of **high-tech lightweight construction materials**, intelligent processing and **pioneering spirit**: these are the ingredients for our unique overall vehicle concept.

They are deeply rooted in our **Carthago Premium DNA**. It is an incentive and an obligation at the same time: The Carthago Premium DNA is our value promise to each Carthago customer, and brings together that which characterises every one of our motorhomes. And at the same time, it is an expression of that which makes Carthago different from other motorhomes. Our core expertise is in motor-

homes in the liner premium class. This because our **40 years of experience** flow into every stage of development and manufacturing. We think that only the best is good enough for your comfort and safety! The materials and construction technologies that we use and the demands that are made of their weight and stability have many similarities to aviation technology.

In this way we can offer you a high degree of durability and value retention, safety, protection and comfort. This makes each Carthago motorhome something special, and therefore a **synonym for exclusivity and quality**. Or, to put it simply, Carthago stands for "The Motorhome".

Long-lasting. High stability.

### Carthago Liner premium-class body construction

Space guaranteed.

### Carthago double floor with huge storage compartment

Well-balanced. Optimum distribution.

### Carthago payload & weight and balance





Well-being – all year round.

### **Carthago heating & air conditioning technology**

Unique. Unmistakable. Extravagant.

### **Carthago Personality**

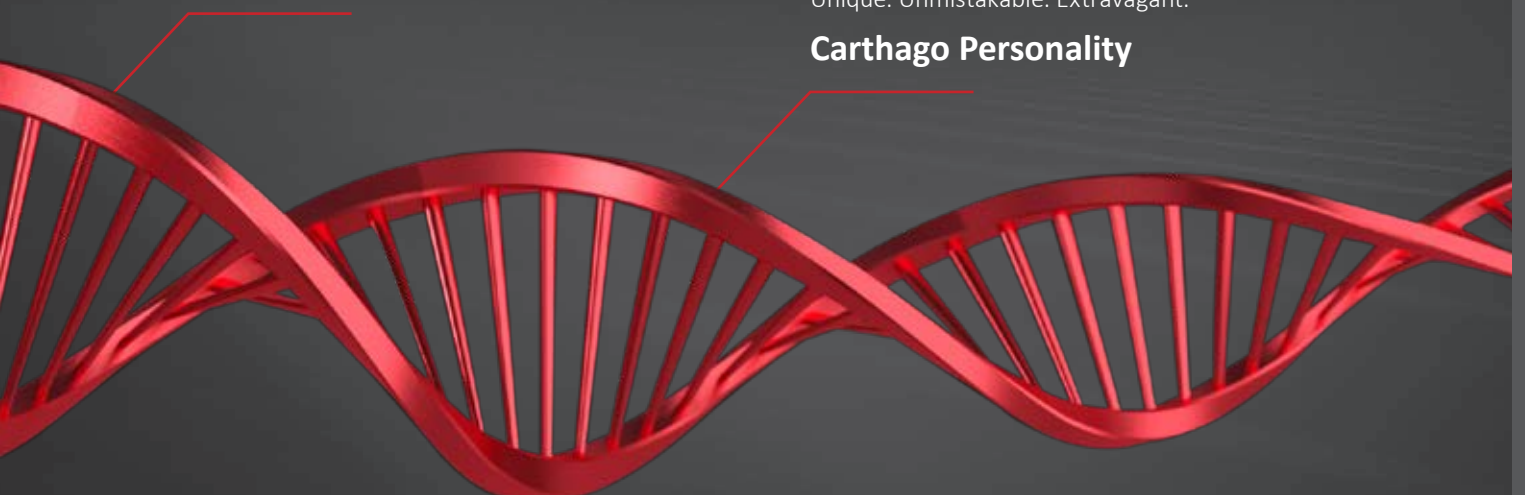

# Liner premium-class body construction

## Advanced technology inspired by aircraft construction

Carthago bodies have strong and durable connections. Where others use screw connections, we apply high-tech. As well as a high degree of stability, a main body reinforced with **frame members** and **special bonding technologies** also provides a clear advantage with regard to safety.

The frame member for connecting the floor and the side walls acts as **side collision protection** if the worst comes to the worst. Thanks to features inspired by aircraft construction, the main cabin is not only highly stable, but also light and torsionally rigid.

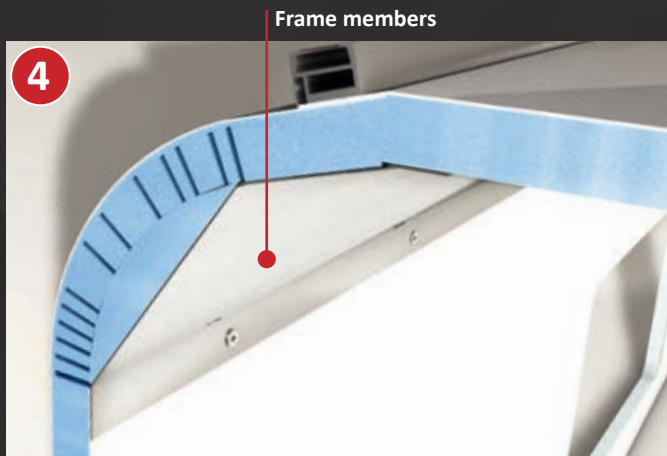

### Carthago roof/wall connection

The typical Carthago curved roof is not only an unmistakable design element but with the frame members on the inside, it makes a decisive contribution to the rigidity of the main cabin. And all of this without any thermal bridges whatsoever. Another safety plus: less sensitivity to side wind.

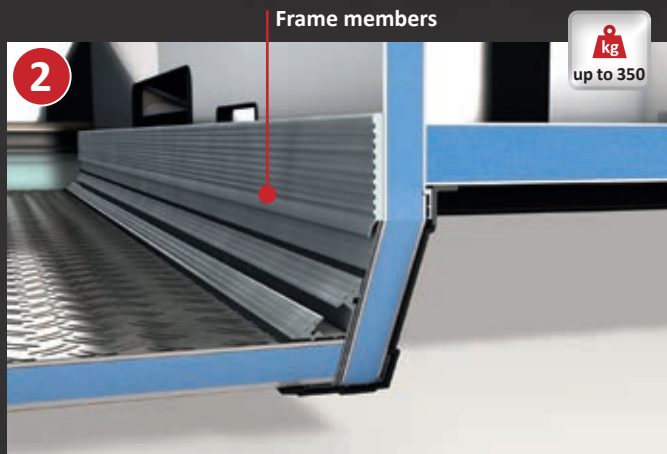

### Carthago low-level scooter garage

Deep lowering of the scooter garage means maximum storage space and minimal effort when loading. An extremely strong wall to floor connection due to form-fitted and bonded frame members provides a load-bearing capacity of up to 350 kg.

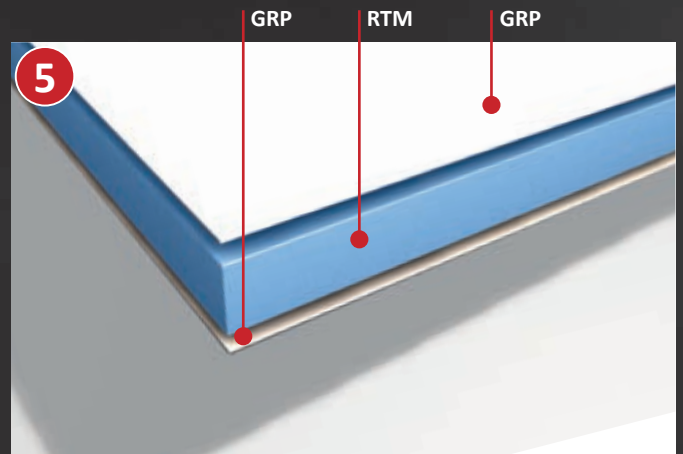

### Carthago floor panel

Provides all-round protection. The lower and upper sides are made from GRP, and between them there is a hard foam insulating core made from RTM Styrofoam. The high-stability floor has lifelong protection against humidity and rotting.



## Your added value

- + **Body connection with high-stability frame members**
- + **Durability and value retention** for many years
- + **Perfect insulation and heat storage**
- + **Maximum body stability** and torsion resistance, the decisive contribution for driving comfort and driving safety
- + **Light vehicle weight** due to self-supporting body design
- + **100 percent wood-free body** no rotting possible – also over the long term

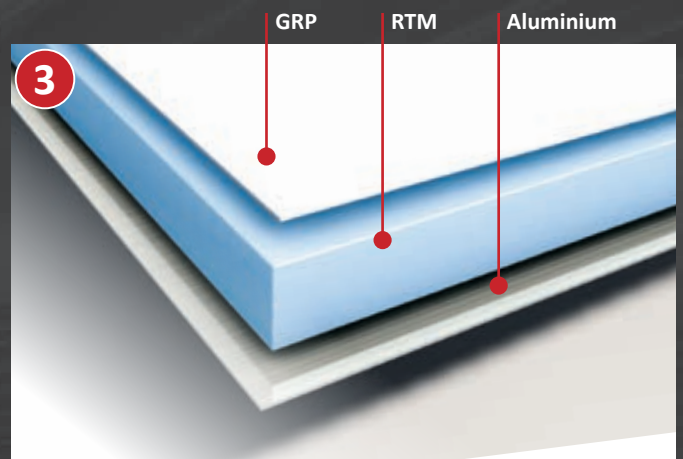

### Carthago roof structure

Having GRP on the exterior means protection from hail, and having aluminium on the interior means protection against lightning strikes. The aluminium interior also takes over the function of heat storage in winter.

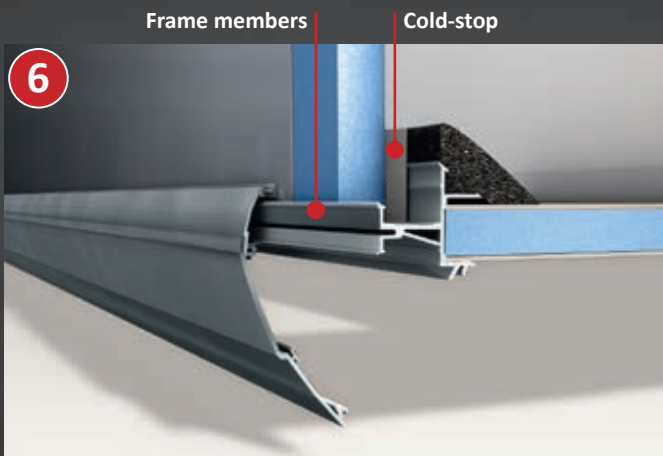

### Carthago floor/wall connection

Provided at both sides via a high-stability frame member. Similarly to aircraft construction, it is form-fitted and bonded along the entire length. And if the worst comes to the worst, it has the effect of side collision protection. An integrated thermal bridge stop reliably prevents any thermal bridges.

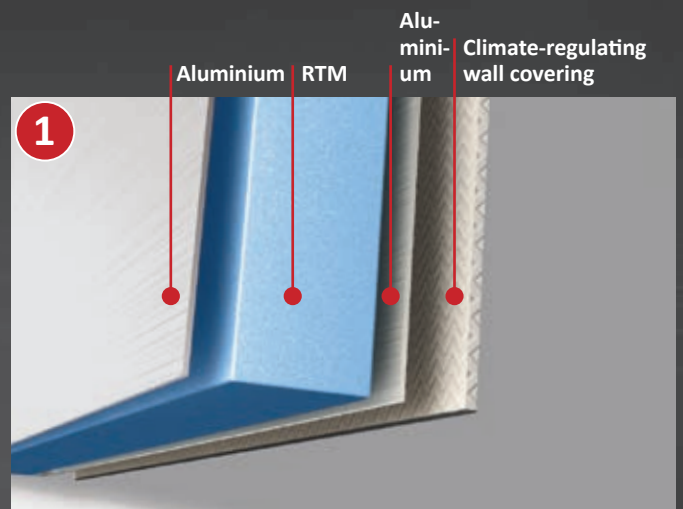

### Carthago side wall construction

Having aluminium not just on the exterior but also the interior of the walls is a prerequisite for efficient heat storage. This produces the typical Carthago well-being climate. The homogeneous heat radiation acts like a wall heater.

# Liner premium-class body construction

## Longevity, protection and value retention

The Carthago body construction consistently orients itself to what Carthago drivers want: long-term carefree driving and value retention. We therefore rely on **long term quality**. GRP and aluminium are used where they are most effective. For your protection and comfort, even in the event of hail, mois-

ture, lightning and cold conditions. The unique chassis connection via **extremely stable frame members** is the guarantee of maximum torsional rigidity. Quality that you can feel – journey after journey, year after year.

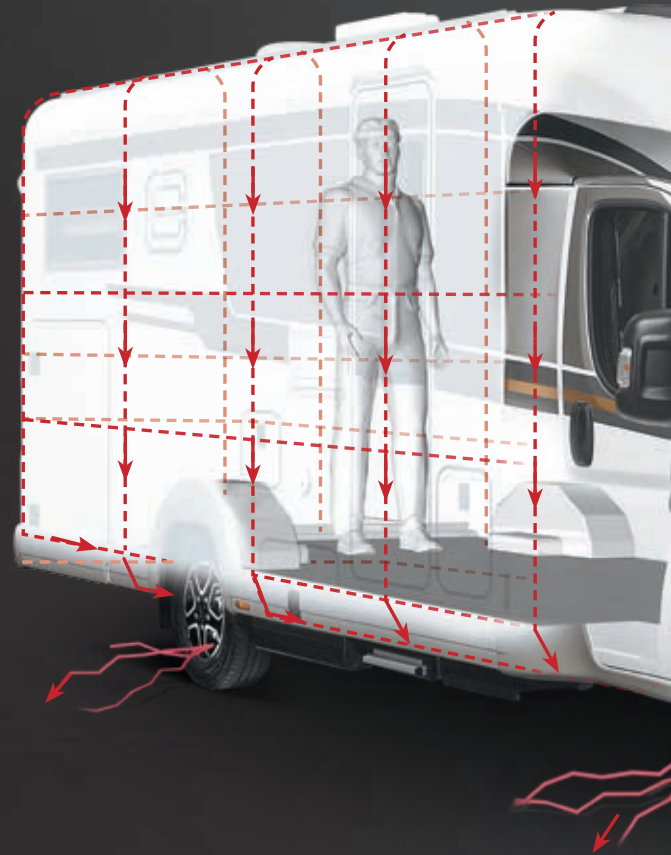
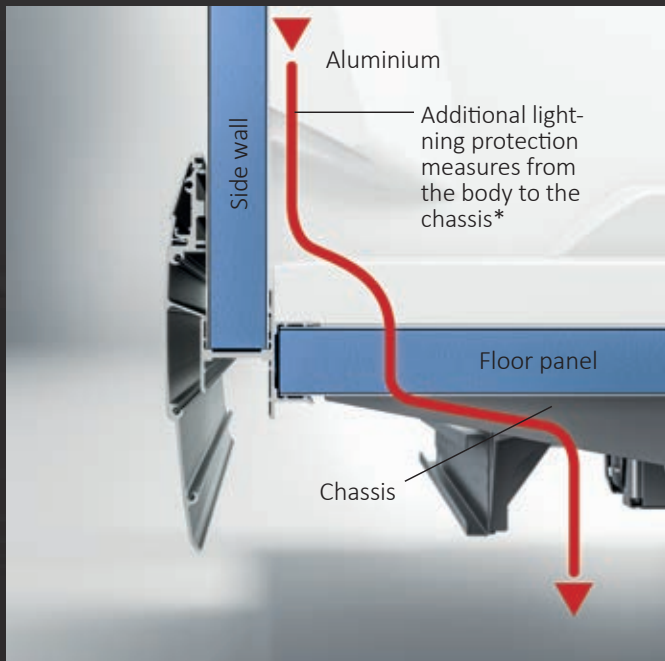

### Tested lightning protection

Aluminium on the roof and inner walls provides protection like a Faraday cage. Additional lightning conductors in the chassis significantly\* increase this protection effect. The lightning protection test has been proven: a Carthago main cabin provides verified protection against lightning strikes!



### Lightning penetration

with conventional GRP roof with wood/GRP roof interior.



## Your added value

- + Tested lightning protection
- + Protection from hailstones and moisture
- + 10 year water ingress warranty
- + Easy to repair in the event of damage
- + Stone chipping and underfloor protection



### Hail protection

thanks to top side of roof being made from GRP. This makes your insurance premiums cheaper. The special feature: The protection against lightning strikes is retained thanks to the aluminium on the inside of the roof.



### Moisture protection

The Carthago body is the guarantee of all-round protection. Its design provides protection from moisture. This promise is backed up by a **ten-year water ingress warranty**.

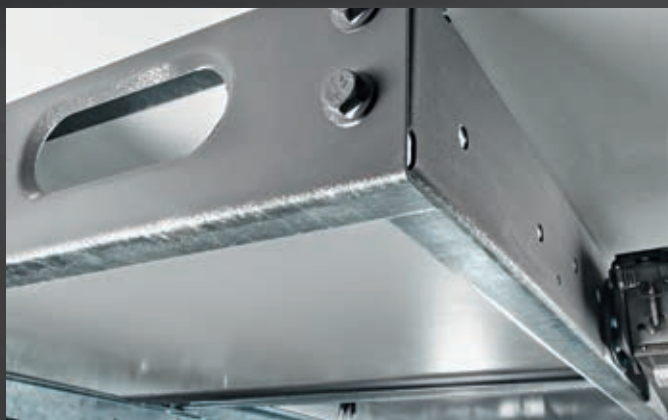

### Stone chipping protection / underride guard

The GRP floor underside provides long-term protection against damage caused by stone impacts, rotting and moisture. For years – without the need for maintenance! The lowered frame of the scooter garage simultaneously acts as an underride guard and reduces collision damage.



### Ease of repair

Wherever possible, attention is paid to segmentation during the development of the main body components. In event of damage, this makes replacement easier and saves money. For example, there is a separately replaceable rear bumper at the rear of every vehicle.

# Double floor with huge storage compartment

## More room for your holiday

You can never have enough storage space in a motorhome! This is why considerable amount of attention is paid to the amount of storage space during the development of the Carthago coachbuilt vehicles.

More than 40 years of consistent development orientation to the individual needs of motorhome enthusiasts is clearly evident in the Carthago storage space solution. Because for optimum practical use, it is not just about the volume but the ease of access for loading and unloading, and also protection from frost.

Thanks to the unique double floor and many extra-deep storage compartments, the Carthago coachbuilt vehicles have plenty of room for your entire holiday luggage! Bulky items such as camping furniture or skis are stowed away in an optimum fashion in the central through-loading space. Numerous large exterior hatches make it easy to load the double floor from the outside. Large, adjustable floor hatches in the living area and the kitchen area give you convenient access to extra-deep low storage compartments from the inside. The double floor also acts as insulation, protecting your cargo from frost.

### Your added value

- + **Biggest storage compartment in its class**
- + **Unique, large double floor**
- + **Convenient exterior and interior access "EASY ENTRY"** - load from the outside, unload from the inside
- + **Extra-deep storage compartments for additional usable height**
- + **Lowered storage compartment elaborately manufactured in original bodywork sandwich**, therefore maximum stability and high-efficiency insulation
- + **Fully usable storage compartment volume**, no restrictions caused by the installation of technical components
- + **Weight and balance - weight optimisation** and additional payload thanks to maximum usable axle loads and balanced weight distribution between front and rear axle





## Approx. 1,280 l double floor storage compartment!

(on the example of the chic c-line l 4.9 LE)

Like the A-Class models, the coachbuilt versions also have a unique double floor with a huge storage compartment



- Double floor with access via interior and exterior hatches (volume approx. 1,280 litres)
- Access to double floor via exterior hatch
- Access to double floor from the inside (seat bench and floor hatches)

# Double floor with huge storage compartment

EASY ENTRY – convenient loading from the outside, easy removal from the inside



**Usable height up to 70 cm**

PASSENGER SIDE



Gas bottle compartment



Scooter garage with large interior height thanks to deep lowering, with access from both sides via two large scooter garage doors at the driver and passenger sides

Load from the outside



Convenient loading of the double floor storage compartment via a large external hatch

Unload from the inside



Easy removal of the storage compartment contents from the inside via the lift-up seat bench cover of the L-shaped lounge seating area with patented fitting

Additional double floor storage compartments



Living area floor hatch with double floor storage box (42 cm usable depth) in heated double floor

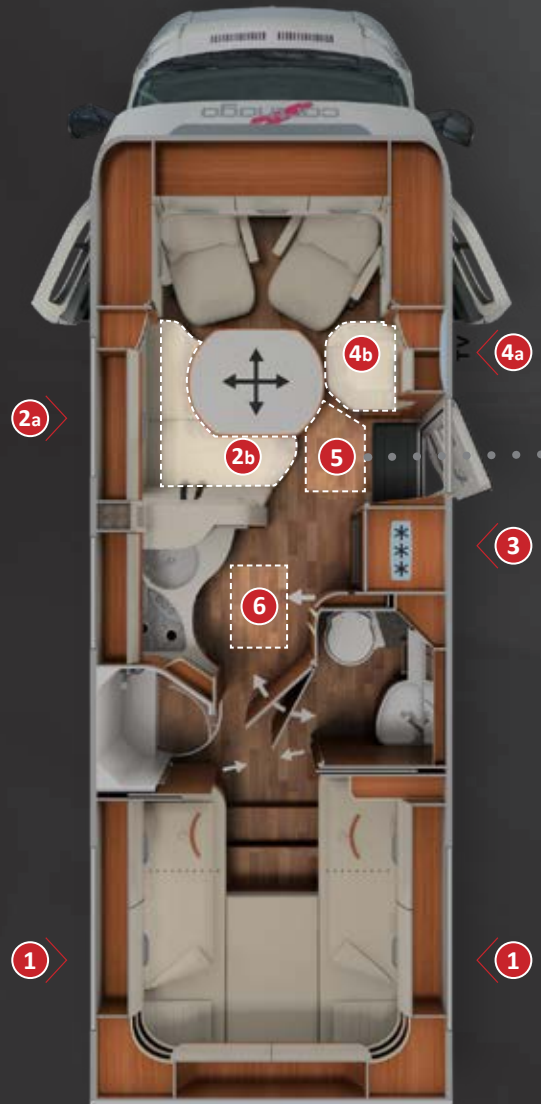



## Your added value

- + **Double floor** with huge, heated storage compartment, usable height up to 70 cm
- + **Access from the exterior** via several large hatches
- + **Access from the interior** via the L-shaped lounge seating area seat bench cover, the lift-up side seat bench and the large living area floor hatch
- + **Large, central through-loading space** (interior height up to 22 cm) with deeply lowered storage compartment (usable height up to 46 cm), also conveniently loadable from the outside through the XL habitation door via the large, self-supporting living area floor hatch
- + **Climate storage function:** the entire double floor is heated with an underfloor heating effect



DRIVERS SIDE



3 Large, additional double floor storage compartment with separate exterior hatch



4a Convenient loading of the double floor storage compartment via a large external hatch

Load from the outside



5 Large living area floor hatch in the entrance area: also easy to load from the outside with the XL habitation door open



4b Convenient removal of contents via the lift-up side seat bench

Unload from the inside

# Carthago Pedelec scooter garage

The garage wonder for queen-size bed models with an interior loading height extension of up to 124 cm

Will your big bike or Pedelec not fit into the rear garage of your motorhome?

Not a problem with Carthago's queen-size bed models. This is how it's done: Just swivel up the rear bed from the outside **with a single manual operation**, park the bike in the garage, **lower the rear bed again**. The Carthago trick: a recess in the

floor accommodates the bike. Securely lash everything – done in an instant and handlebar heights of up to 124 cm are possible in combination with the swing-up bottom edge of the bed. In spite of this, the bed is easily accessible from the inside at any time thanks to the low position. Just another one of the many great Carthago ideas. And because it's so good, we've **registered it for patent.** <sup>(1)</sup>



**Pedelec scooter garage**

Available with the model series with queen-size beds



**Easy loading**

of a Pedelec using the push-in system with the hook-on drive-in ramp



## Your added value

- + **Patented<sup>(1)</sup>: Carthago Pedelec scooter garage**
- + **Interior height extension**  
of the Pedelec scooter garage to up to 124 cm in the queen-size bed models
- + **In spite of low bed access**  
Bike with handlebar height of up to 124 cm can be transported in the rear garage, no unloading required in order to sleep
- + **Innovative solution**  
With easy operation
- + **Cover for the recess in the floor**  
can therefore also be used as an additional storage compartment with a level garage floor



**Loading height extension**  
by simply swivelling up the interior rear bed with one hand and the additional lowered floor recess

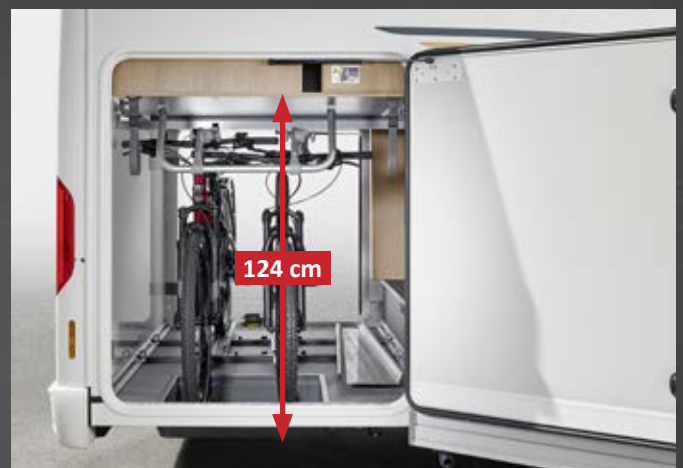

Handlebar height of up to 124 cm is therefore possible

# Carthago payload & weight and balance

## Additional safety and comfort due to optimum weight distribution

No fear of the scales: a Carthago has reserves, even for large luggage items! You will find a heavy payload in the construction specification of every new Carthago. Because this forms the basis for outstanding comfort, independence and safety when you are travelling. It is a natural constituent of the Carthago Premium DNA. A harmonious weight balance is a matter of course for a Carthago. The basis is formed by load-bearing chassis with two axles, which provide an individual solution for the respective requirement. Clever wheelbases ensure that the

weight distribution is favourable, utilise the maximum axle loads and lead to a safe and confident driving style at the same time. Intelligent lightweight construction technology reduces the weight of the vehicle. Carthago also means not having to forego anything with regard to payload, since holidaymakers do not have to restrict themselves, even on long trips: you can simply take your favourite things from clothing to Pedelecs with you in the huge storage compartments. And the reserves in the Carthago are always sufficient for your holiday souvenirs.

## Maximum payload reserves – with the best possible balancing\*

(on the example of the c-tourer T 143 LE)





## Your added value

### + Travel comfort

No restrictions as far as holiday luggage is concerned, and optimum utilisation of the potentially record-breaking storage compartments in the Carthago motorhome

### + Weight and balance - weight optimisation

Additional payload due to balanced weight distribution between front and rear axle

### + Many individual weight variants

Result in individual reserves for each model and each configuration

### + Maximum safety on the road

No risk due to overloading and over-stressed components, safe driving style



#### The Carthago double floor

Together with the high-stability self-supporting main body construction, it contributes to providing a high degree of stability and torsional rigidity, and is extremely light-weight at the same time. A "special light" AL-KO low frame is used exclusively for the lightweight models. Result: minimal vehicle weight – maximum payload.



#### Balanced weight distribution

Large storage compartments and sufficient payload alone are not enough. Carthago uses wheelbases which are coordinated in a model-specific way. The result is an optimum weight balance between the front and rear axles – the prerequisite for practical use of the storage space.

## Press opinions

„The generous double floor not only holds storage space, but is also heated. [...] It has: Primarily sufficient storage space for containing a couple's entire household contents. This is not only made possible by the clever conception and division of the storage compartments in the interior, but also by the heated double floor, which is easily accessible from inside and outside, and the spacious rear garage.“

**AutoBild Reisemobil 04/2021,**  
c-tourer T 143 LE travel report

“[...] a well-equipped Carthago with the Sprinter traction unit and an AL-KO low frame chassis feels fantastic to drive: Comfortable, quiet and remarkably nippy. The powerful and quiet-running engine makes driving on uphill sections of the motorway and acceleration a breeze.“

**Camping Life Autozeitung 04/2021,**  
c-tourer T 143 LE test report

# Carthago heating and air conditioning technology

Cosy and comfortable, just like at home

We can't think of any reason why you should have to forego a good climate, regardless of where you are travelling to, and when. For this reason, a Carthago provides year-round comfort thanks to technical refinements such as heat-reflecting walls, targeted heating of the on-board equipment and heat

circulation throughout the double floor. This provides the best conditions for a **real well-being climate during both summer and winter**. Because that which insulates and keeps the heat in during the winter also keeps you cool during the summer.

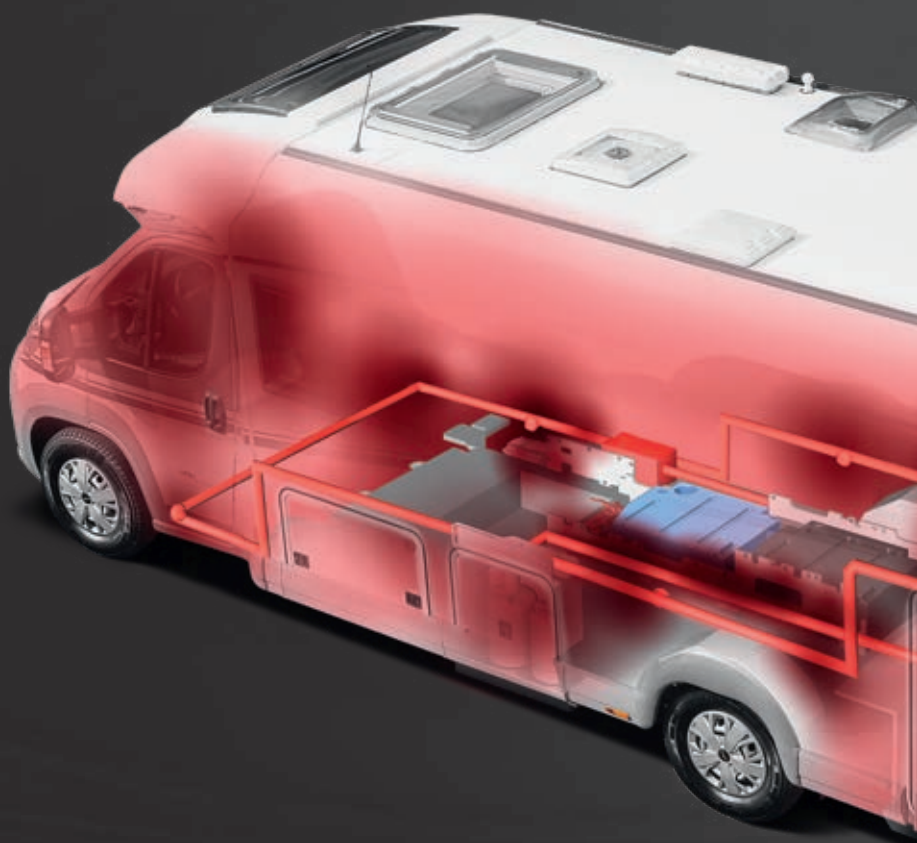

**Truma Combi 6 warm air storage heating system** with numerous warm air outlets throughout the double floor, the living area, the roller garage and the cold-sensitive door entrances.



**Carthago underfloor heating effect** Numerous hot air outlets and heat circulation channels in the double floor ensure that the heat is evenly distributed. This heat accumulation radiates upwards towards the floor of the living area and gives it a pleasant warmth. You always have warm feet in a Carthago.





## Your added value

- + **Aluminium interior walls**  
= 1,000 times better heat distribution than conventional wooden interior walls
- + **Winter-proof motorhome**  
with year-round comfort
- + **Underfloor heating effect**  
your feet are always warm
- + **No undesirable draughts**  
thanks to cold stops in critical locations
- + **Even heat distribution**  
and radiation due to the aluminium inner wall
- + **Heat storage effect**  
and efficient insulation reduce gas consumption
- + **Targeted heating**  
of all technology components safeguards functionality

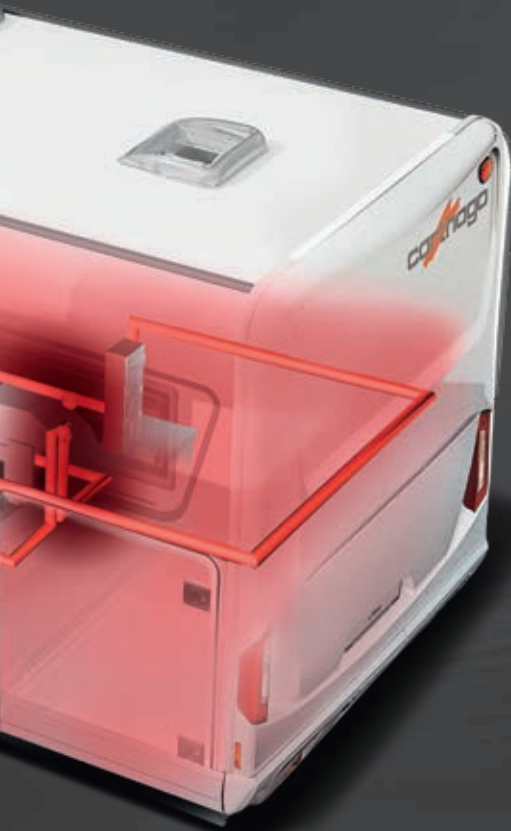

### Heated technical components

Heating is a standard feature in a motorhome. So is the fact that it heats the living area. Areas which are sensitive to cold are provided with targeted heating in a Carthago motorhome: all technical components such as tanks, batteries, storage compartments, doorways, etc. This is the guarantee of full functionality, even at low minus temperatures.

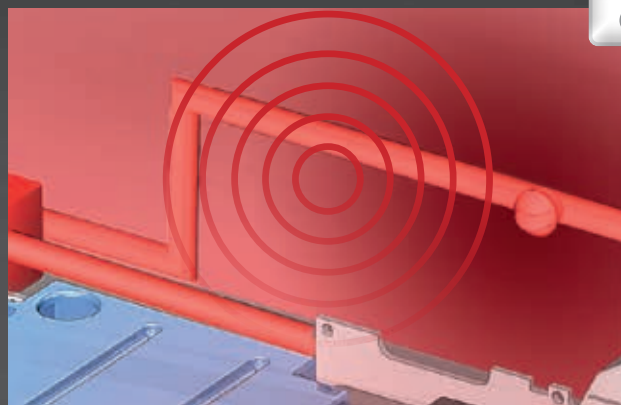

### Carthago wall heater effect

Aluminium that is also on the insides of the walls stores the heat that is absorbed and evenly gives it off again. This results in a very pleasant wall heater effect. Aluminium conducts heat 1,000 times better than conventional inside walls made from timber.

# Carthago Personality

**Distinctive, unmistakable, unique:** a Carthago is THE face in the crowd. It is as individual as its owner. The evolutionary Carthago design sets standards that go beyond the motorhome industry. **Shape and function** combined into a perfect symbiosis. Powerful radiator grille and elegant cab mask, stylishly rounded transition from the side walls to the roof, offset sills and a sturdy rear – together with the subtle décor,

this all combines to produce the typical Carthago look with harmonious shapes and flowing lines. **Every detail is well thought-out.** The windows and hatches of the habitation are flush-mounted in the side walls. Even the filler cap of the coachbuilt motorhome is flush-mounted. The rear lights from the rear of the vehicle – with Carthago C-branding in LEDs.



**The Carthago curved roof.** Carthago awakens emotions with its unique and elegant design and the curved roof which is typical of the brand. It also increases the torsion resistance of the body, and there is less susceptibility to side wind. The perfect combination of design and practicality!



**Carthago front shroud** combines elegant design and high quality GRP construction.



**The GRP rear** with the bus look of the chic c-line coachbuilt sets standards with regard to design thanks to its sporty and elegant exterior look.



**Workmanship quality: furniture from our own joinery shop**, manufactured and fitted piece by piece with meticulous craftsmanship – nothing wobbles or rattles. It is no coincidence that Carthago always achieves the best results for its outstanding processing quality. Carthago furniture design is a quality feature that is mentioned again and again. Thanks to the double connection technology, highly stable and designed for a long life.



## Your added value

- + **Striking and individual design concept**
- + **Elegance and dynamics**  
thanks to three-dimensional shapes and curves
- + **Flat bodywork surfaces**  
thanks to the invisibly recessed hinges, the flush-mounted fuel tank flap
- + **Furniture made in our own Carthago joinery shop**
- + **Stable “Durafix” double connection technology**  
screwed together and mortised
- + **No creaking or rattling while driving**  
noise reduction by means of anti-knocking cushioning
- + **Stays, hinges and runners**  
in solid household quality
- + **Seating comfort on long journeys**  
thanks to ergonomically designed top quality upholstery
- + **Indirect lighting with LED lighting technology**  
for a cosy atmosphere



**LED lighting technology: bright reading light or cosy ambient lighting** – made possible by the Carthago LED lighting technology. Numerous spotlights in the right locations and effective indirect lighting in appropriate locations provide impressive effects. And this is also power-saving and long-lasting.

# Our powerful partners

## Top class partners for top class quality

A top chef only uses the best ingredients for a first class menu. Only selected components are also used for top class motorhomes. We have chosen strong partners for your Carthago - strong in performance, strong in quality and strong in service.

So that you can enjoy your holiday in a Carthago in a relaxing way, just like you would enjoy a Michelin-starred menu. Would you like to upgrade your Carthago into your own personal travel dream? If so, we recommend having your original Carthago accessories factory-installed.



**Aguti**

[www.aguti.com](http://www.aguti.com)



Aguti seats are multi-talented with regard to comfort, safety and ergonomics. They are specially tailored to the requirements of motorhomes, and fulfil all travelling and living requirements. The seats are guaranteed to provide healthy seating that supports your body, thanks to the anatomically adapted contact surfaces for the legs and back.



**Alois Kober GmbH**

[www.alko-tech.com](http://www.alko-tech.com)



Carthago puts its trust in innovative AL-KO technology such as the AMC chassis with torsion bar suspension and individual wheel suspension for more comfort and safety and also the high-strength and hot-dip galvanised AL-KO lightweight construction technology for more storage space and more payload. But also the innovative and modern hydraulic supports and pneumatic suspension systems with intuitive operation.

# alphatronics

## alphatronics – Size in detail

[www.alphatronics.de](http://www.alphatronics.de)



All of the televisions in your Carthago motorhome are manufactured by alphatronics in Nuremberg. This ensures that you get consistently high quality, so that all your expectations of a reliable motorhome television are fulfilled. The “Made in Germany” quality claim is not only manifested during the manufacture of the devices, but starts during development. The company is always at the cutting edge due to having its own development department, and has been impressing its customers for years with innovations for mobile use.

 **DOMETIC**  
Mobile living made easy.

## DOMETIC

[www.dometic.com](http://www.dometic.com)



**DOMETIC 10 series – keep it fresh, keep it cool.** The new 10 series by Dometic has completely redefined the standards for mobile refrigerators: double sided door stop for access from both sides, aluminium handles over the entire height of the fridge, intuitive control with TFT display and the best cooling power in this class!

# Our powerful partners

Top class partners for top class quality



**Super B**

[www.super-b.com](http://www.super-b.com)



Super B supplies the lithium batteries for Carthago. These high-end lithium batteries provide tremendous energy reserves and are much lighter, easy to install and have a considerably longer shelf life than other batteries. The Epsilon battery was specially developed for use in motorhomes. Due to the company's own intelligent battery management (BMS) and Bluetooth functionality, you are always kept informed about the current status of the battery and the amount of energy that is available. You will enjoy a high degree of self-sufficiency and optimum comfort on your trip with Carthago and Super B.



**Teleco**

[www.telecogroup.com](http://www.telecogroup.com)



The Teleco Group is one of Europe's leading companies in the camping accessories area. Teleco stands for quality products in the areas of satellite systems, televisions, air conditioning systems and generators. Particularly in satellite systems and televisions, the products excel because of their high quality, precision and innovative technology. More than 40 years of experience and a pan-European service network make Teleco a reliable partner. This is why Carthago puts its trust in its satellite systems.



**Thule**  
[www.thule.com](http://www.thule.com)



Travelling with your leisure vehicle means freedom: you can start whenever you want, and go wherever you want. You can stop in the most beautiful locations and enjoy living outdoors. A Thule awning is the perfect way to have a protected area next to your vehicle. Check out our smart blockers, tents, bike racks and much more!



**Truma Gerätetechnik GmbH & Co. KG**  
[www.truma.com](http://www.truma.com)



Camping enthusiasts like to go on holiday all year round – and they have the comfort which they are accustomed to thanks to the Truma heating systems. The Combi heating systems combine two functions in one device. They heat the living area and also the water. The Combi heaters can be powered by gas, electricity, diesel or a combination of fuels, depending on the model. Discover the next generation of our Truma Combi D!

Carthago Reisemobilbau GmbH  
www.carthago.com



Changes may occur during the model year after the editorial deadline for this printed document in July 2022. The manufacturer reserves the right to make structural and design changes that become necessary, provided they are in the interest of technical progress and are reasonable for the customer, plus changes to equipment, differences in colour combinations or individual colour shades, material quality differences and changes to the scope of delivery on the part of the manufacturer. This also applies to colour differences on basic vehicles, insofar as they are a result of changes made by the basic vehicle manufacturer. Please consult your dealer for detailed advice concerning the status of the current product or series.

The information about the scope of delivery, appearance, performance, dimensions and weights of the vehicles (differences within the scope of the factory tolerances ( $\pm 5\%$  max.) are possible and permissible) corresponds to the state of knowledge at the time of going to print. Please be aware that some of the vehicles are depicted with special equipment for which an additional charge applies. In some cases they are shown with equipment features that do not correspond to the series production version and are also not available as special equipment. The decoration depicted in the catalogue is not a constituent of the scope of delivery. More technical information can be found in the price list.

Prior written consent from Carthago Reisemobilbau GmbH is required for the reprinting of this publication or extracts thereof. The information in this publication is compliant with the German StVO and StVZO (road traffic and road traffic licensing regulations). No liability accepted for errors and/or misprints.

<sup>1)</sup> Patents are model- and country-specific